



SPRING INTO SAVINGS



Solid Carbide Tiny Tools Coolant Through – Grade BXC

A Family of Tools Designed for Working in Small Bores

- PVD TiN coated for low cutting speed
- Works well with a wide range of steel and stainless steel
- Used in machining centers or with conventional machines
- Coolant-through enables cooling fluid to reach cutting edge efficiently
- Coolant-through aids in chip removal to help achieve smooth cutting action
- The Carmex line-up of Tiny Tools support most turning applications such as thread turning, grooving, chamfering, profiling, boring, and more

CHOOSE YOUR **FREE** HOLDER



Reference key: Torx®15

- 3/4" diameter **For 3mm Bars | Code 570102**
- Length: 3-1/2" **For 4mm Bars | Code 570104**
- For 6mm Bars | Code 570106**

BUY 5 CARMEX TINY TOOL BARS BELOW AND RECEIVE YOUR CHOICE OF HOLDER **FREE**

MGR Grooving Bars



- MGR 4 B1.5 L10 BXC Ø 4mmCode 570088 | **39.20**
 MGR 6 B2.0 L15 BXC Ø 6mmCode 570090 | **40.74**

MTR Boring Bars



- MTR 2 R0.15 L10 BXC Ø 3mmCode 570092 | **39.38**
 MTR 4 R0.2 L15 BXC Ø 4mmCode 570094 | **43.58**
 MTR 6 R0.2 L22 BXC Ø 6mmCode 570096 | **51.85**

MPR Profiling Boring Bars



- MPR 2 R0.15L10 BXC Ø 3mmCode 570070 | **39.38**
 MPR 4 R0.2L15 BXC Ø 4mmCode 570072 | **43.58**
 MPR 6 R0.2L22 BXC Ø 6mmCode 570074 | **51.85**

MIR Threading Bars – Partial Profile 60°



- MIR 3 L15 A60 BXC Ø 3mmCode 570076 | **45.90**
 MIR 4 L15 A60 BXC Ø 4mmCode 570078 | **45.90**
 MIR 6 L15 A60 BXC Ø 6mmCode 570080 | **47.82**

FOR ALL DIMENSIONS GO TO KAR CATALOG 2017 pgs 247-249: https://kar.ca/pdf/KAR-CAT17_Grooving_245-249.pdf

YOUR AUTHORIZED KAR DISTRIBUTOR:

TECHNICUT

INDUSTRIAL SUPPLY INC.

Unit 201-9466 189th Street, Surrey, B.C. V4N 4W7

604.888.4052 Fax 604.888.4072



SPRING INTO SAVINGS

20% OFF ALL MAGAFOR MICRO DRILLS

Micro Drills

FOR PRECISE AND PERFORMANCE DRILLING



Carbide – Pre-Drilling & Flute Lengths: 3 x D | 5 x D | 8 x D | 12 x D | 15 x D

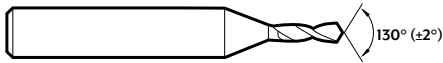
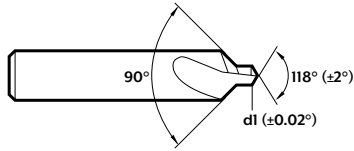

Series 82X3 Micro Drills shown

Description	Size	Price
PRE-DRILLING Series 82X1 Ensures a precise location and perfectly aligned holes Select a smaller diameter "d1" than the drill size	0.10 to 0.30 mm x 0.05 mm increments 0.30 to 0.60 mm x 0.10 mm increments 0.60 to 1.00 mm x 0.20 mm increments 118° point (±2°)	Starting at... 53^{.66}
3 x D Series 82X3	0.10 to 3.00 mm x 0.05 mm increments 130° point (±2°)	Starting at... 27.76
ALSO AVAILABLE HARD-X COATED 5 x D Series 82X5	0.10 to 3.00 mm x 0.01 mm increments 130° point (±2°)	Starting at... 22^{.66}
8 x D Series 82X8	0.10 to 2.05 mm x 0.01 mm increments 130° point (±2°)	Starting at... 22^{.66}
12 x D Series 82X12	0.30 to 2.05 mm x 0.05 mm increments 130° point (±2°)	Starting at... 41.15
15 x D Series 82X15	1.00 to 2.05 mm x 0.05 mm increments 140° point (±2°)	Starting at... 243^{.53}

ASK FOR MORE DETAILS OR GO TO: https://kar.ca/pdf/REFERENCE_MAGAFOR_MicroDrills_may0620-1816.pdf

Chamfering Biconical Cutters

K15 Carbide – Front & Back – Standard 4 Flute Bi-Face 90° Angle & Hard'X 90° Angle



BI-FACE: For superior finish operations, Bi-face has a constant relieved profile. Longitudinal or interpolated work for front and back chamfering of edges and holes.



HARD'X: AlTiN carbide tool coating with a high hardness of 3500 HV. This coating shows high thermic stability and excellent protection against heat and wear. Ideal for dry machining – high speed cut – in treated steels and dies up to 67 HRC.

- Special design equals positive cut plus relieving profile
- Unequaled surface finish
- Impressive performance
- Extended tools profile life

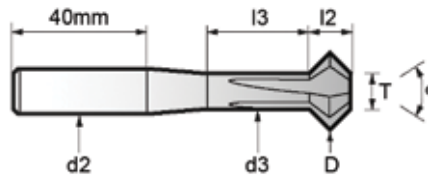

Tolerances (Inch)			
D	Tolerance	L	Angle
0.04 - 0.197	0 - 0.002	±0.04	±1°
0.236 - 0.63	0 - 0.004		

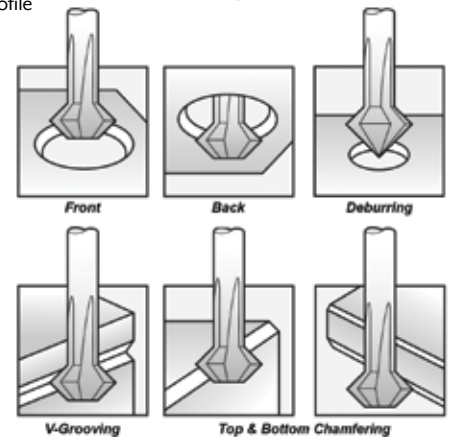

WATCH BI-FACE IN ACTION
VIDEO: <https://kar.ca/downloads/videos>

Ø Inch (mm)	d2 (Inch)	d3 Max. (Inch)	T Max. (Inch)	L Min. (Inch)	I2 (Inch)	I3 (Inch)	BI-FACE 90° Angle (Series 8490)		HARD'X 90° Angle (Series 8490-H)	
							Code	Price	Code	Price
0.118 (3)	0.236	0.087	0.047	4	0.051	0.394	314198	61 ^{.86}	314222	69 ^{.14}
0.157 (4)	0.236	0.114	0.063	4	0.069	0.472	314201	64 ^{.16}	314225	61 ^{.86}
0.197 (5)	0.236	0.134	0.079	4	0.091	0.591	314204	67 ^{.63}	314228	64 ^{.93}
0.236 (6)	0.236	0.154	0.094	4	0.114	0.709	314207	71 ^{.04}	314231	68 ^{.05}
0.315 (8)	0.236	0.193	0.193	4	0.118	1.339	314210	92 ^{.80}	314234	88 ^{.69}
0.394 (10)	0.236	0.232	0.232	4	0.157	1.339	314213	113 ^{.45}	314237	108 ^{.26}
0.472 (12)	0.236	0.232	0.232	4	0.236	1.339	314216	136 ^{.31}	314240	129 ^{.92}
0.630 (16)	0.394	0.311	0.311	4	0.315	1.339	314219	182 ^{.18}	314243	192 ^{.43}



CNC Spotting Drill Sets

HSS-E Cobalt & RED-X Coating

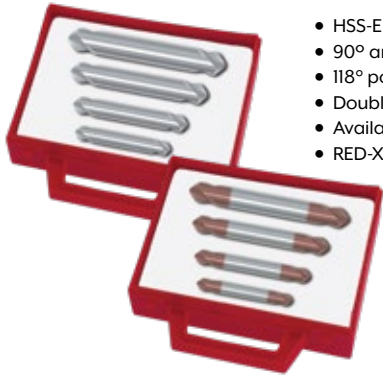

- HSS-E Cobalt and RED-X
- 90° angle
- 118° point geometry offers improved penetration rates while reinforcing the point
- Double ended for cost savings
- Available in 4-Piece sets or sold individually
- RED-X coating provides increased speeds and feeds and allows machining up to 55 HRC

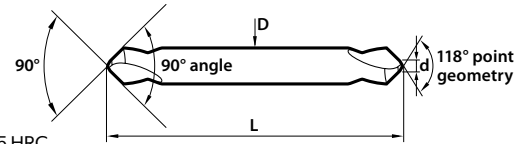

D (Inch)	d (Inch)	L (Inch)	Series 019 HSS-E Cobalt	Series 0919 RED-X Coated
3/16	1/16	2	4-Piece SET Code 540090	4-Piece SET Code 540095
1/4	3/32	2	61.47	88.62
3/8	9/64	3		
1/2	3/16	4		

Pipe Taps

High Speed Steel – Straight Flute, Spiral Flute & Interrupted Thread

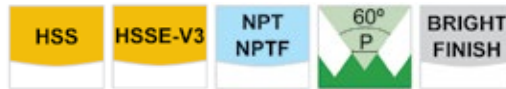

HSS – Straight Flute



- For cast iron and steel applications
- NPT and NPTF standards

HSSE-V3 – Spiral Flute



- For cast iron, steel and stainless steel applications
- NPT and NPTF standards
- High speed steel substrate with cobalt and 3% vanadium content for cutting stainless steels up to 29 HRC and tool steels up to 35 HRC

HSS – Interrupted Thread



- For cast iron and steel applications
- Reduces cutting pressure
- NPTF standards

Size (Inch)	Threads per Inch	No. of Flutes	Overall Length (Inch)	Thread Length (Inch)	STRAIGHT FLUTE		SPIRAL FLUTE		INTERRUPTED THREAD	
					Code	Price	Code	Price	Code	Price
1/16	27	4	2-1/8	0.688	915700	18 ^{.92}	915716	23 ^{.14}		
1/8	27	4	2-1/8	0.750	915701	20 ^{.71}	915717	25 ^{.59}	915710	26 ^{.58}
1/4	18	4	2-7/16	1.063	915702	22 ^{.54}	915718	28 ^{.52}	915711	29 ^{.02}
3/8	18	4	2-9/16	1.063	915703	28 ^{.65}	915719	36 ^{.67}	915712	36 ^{.84}
1/2	14	4	3-1/8	1.375	915704	32 ^{.03}	915720	42 ^{.78}	915713	41 ^{.15}
3/4	14	5	3-1/4	1.375	915705	50 ^{.28}	915721	66 ^{.50}	915714	64 ^{.60}
1	11-1/2	5	3-3/4	1.750	915706	78 ^{.75}	915722	105 ^{.44}	915715	101 ^{.04}
1-1/4	11-1/2	5	4	1.750	915707	123 ^{.73}	915723	167 ^{.66}		
1-1/2	11-1/2	7	4-1/4	1.750	915708	188 ^{.45}	915724	252 ^{.19}		
2	11-1/2	7	4-1/2	1.750	915709	308 ^{.69}	915725	408 ^{.15}		

Deburring Blade Sets

Multi-Purpose – TiN Coated



Code 551001

35.17



Code 551000

42.56



SET B

Standard

5 pair of B blades:
B10P (2), B11P (2),
B12P (2), B20P (2),
and B30P (2)

SET E

Heavy Duty

5 pair of E blades:
E100P (2), E110P (2),
E111P (2), E200P (2),
E300P (2)

HAND DEBURRING MADE EASY!



Find the right tool for the job!

<https://shaviv-genius.com/>

EXCLUSIVELY AVAILABLE FROM KAR IN CANADA: <https://kar.ca/catalogsearch/result/index/?dir=asc&limit=45&order=relevance&q=SHAVIV>



SPRING INTO SAVINGS



CERAMIX Sets

Heavy Duty Handles with Ceramic Blades

- Adjust cutting angle between blade and material for best results and prevent scratches
- Blade can be flipped for two types of jobs

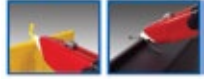

SET Q10 Heavy Duty Handle with Ceramic Q10 Blade



Q10 Set
with Q10 Blade
Code 550722
27.68

SET Q12 Heavy Duty Handle with Curved Ceramic Q11 Blade



Q12 Set
with Q11 Blade
Code 550726
27.68

Individual Ceramic Blades



Side 2:
Cleans up to 0.236" (6mm) sheets
Cleans up to 0.157" (4mm) sheets

Q10 Blade
Code 550723
16.99



Side 2:
(same as Q10)

Q11 Curved Blade
Code 550728
16.99

EXCLUSIVELY AVAILABLE FROM KAR IN CANADA: <https://kar.ca/catalogsearch/result/index/?dir=asc&limit=45&order=relevance&q=SHAVIV>

Keyway Broaches & Shims

High Speed Steel & TiN Coated



Size	Dimensions (Inch)	No. of Shims Required	Tooth Pitch (Inch)	No. of Teeth	Min. LOC (Inch)	Max. LOC (Inch)	HSS		TiN Coated	
							Code	Price	Code	Price
1/16 A	1/8 x 5	0	3/16	18	13/64	1-1/8	605515		-	
3/32 A	1/8 x 5	0	3/16	18	13/64	1-1/8	605516	100.39/ea.	605537	185.22/ea.
1/8 A	1/8 x 5	1	3/16	18	13/64	1-1/8	605517		605538	
3/32 B	3/16 x 6-3/4	0	9/32	16	19/64	1-11/16	605518		605539	
1/8 B	3/16 x 6-3/4	1	9/32	16	19/64	1-11/16	605519	119.43/ea.	605540	207.72/ea.
5/32 B	3/16 x 6-3/4	1	9/32	16	19/64	1-11/16	605520		605541	
3/16 B	3/16 x 6-3/4	1	9/32	16	19/64	1-11/16	605521		605542	
3/16 C	3/8 x 11-3/4	1	3/8	20	25/64	2-1/2	605522		605543	
1/4 C	3/8 x 11-3/4	1	3/8	20	25/64	2-1/2	605523	150.59/ea.	605544	292.53/ea.
5/16 C	3/8 x 11-3/4	2	3/8	20	25/64	2-1/2	605524		605545	
3/8 C	3/8 x 11-3/4	2	3/8	20	25/64	2-1/2	605525		605546	
5/16 D	9/16 x 13-7/8	2	5/8	17	1	6	605526		605547	
3/8 D	9/16 x 13-7/8	2	5/8	17	1	6	605527	230.24/ea.	605548	396.41/ea.
7/16 D	9/16 x 13-7/8	3	5/8	17	1	6	605528		605549	
1/2 D	9/16 x 13-7/8	3	5/8	17	1	6	605529		605550	
5/8 E	3/4 x 15-1/2	4	5/8	20	1	6	605530	384.30/ea.	605551	631.80/ea.
3/4 E	3/4 x 15-1/2	5	5/8	20	1	6	605531		605552	
7/8 F	1 x 20-1/4	6	5/8	26	1	6	605532	791.06/ea.	605553	1180.56/ea.
1 F	1 x 20-1/4	7	5/8	26	1	6	605533		605554	
1-1/8	1-1/8 x 20-1/4	8	5/8	26	1	6	605534	2152.38		
1-1/4	1-1/4 x 20-1/4	9	3/4	22	1-1/2	8	605535	2405.58		

Individual Broach Shims



Broach Size	Shim Thickness (Inch)	Code	Price
1/8 A	0.0310	605555	
1/8 B	0.0310	605556	
5/32 B	0.0420	605557	6.99/ea.
3/16 B	0.0500	605558	
3/16 C	0.0500	605559	
1/4 C	0.0625	605560	
5/16 C	0.0550	605561	6.93/ea.
3/8 C	0.0625	605562	
5/16 D	0.0560	605563	9.53/ea.
3/8 D	0.0625	605564	
7/16 D	0.0560	605565	9.80/ea.
1/2 D	0.0625	605566	
5/8 E	0.0625	605567	9.94
3/4 E	0.0625	605568	9.68
7/8 F	0.0625	605569	11.54
1 F	0.0625	605570	11.63
1-1/8	0.0625	605571	11.48
1-1/4	0.0625	605572	23.27





ALL IN-STOCK CARBIDE BURRS ON SALE NOW

Carbide Burrs

Double Cut, Spiral Cut & Aluminum Cut Fluting Styles



Double Cut

Most popular fluting style. Has both right and left hand flutes which combine to produce a chisel type cutting edge. The chisel edge permits faster penetration and stock removal while the reduced pull of the tool allows better control and reduces operator fatigue. Chips produced by the double cut are smaller than spiral cut which allows the tool to be run at slower speeds if necessary.

Spiral Cut

Second most popular fluting style. Has only right hand spiral flutes and is intended for general purpose use on cast iron, steel, copper and brass alloys, and other ferrous materials. Offers good stock removal and excellent surface finishes

Aluminum Cut

Outstanding for rapid stock removal on soft or non-ferrous type materials. The wide flute design permits easy chip disposal. Aluminum cut burrs have special flute relief design for added strength and longer tool life. Use the aluminum cut design on aluminum, magnesium, brass, zinc alloys, lead, hard rubber and most plastics.



STYLE SA 3 CYLINDRICAL
Double Cut – Ø3/8" Code
938451

18.21



STYLE SC 3 RADIUS CYLINDRICAL
Double Cut – Ø3/8" Code
938376

20.34



STYLE SD 3 BALL
Double Cut – Ø3/8" Code
938456

16.65



STYLE SF 3 RADIUS TREE
Double Cut – Ø3/8" Code
938588

20.25



ASK FOR MORE DETAILS OR GO TO: <https://kar.ca/catalogsearch/result/index/?cat=31&limit=45&q=BURR>

ALL IN-STOCK 1/4" GENERAL PURPOSE A-SHAPE MOUNTED POINTS ON SALE NOW



Mounted Points

A-Shape 1/4" Shank

Shape	Diameter (Inch)	Length (Inch)	Code	Price	Shape	Diameter (Inch)	Length (Inch)	Code	Price
A1	3/4	2-1/2	725101	5.62	A24	1/4	3/4	725124	2.19
A2	1	1-1/4	725102	3.43	A25	1	-	725125	2.73
A3	1	2-3/4	725103	6.58	A26	5/8	-	725126	2.33
A4	1-1/4	1-1/4	725104	3.83	A31	1-3/8	1	725131	3.22
A5	3/4	1-1/8	725105	3.40	A32	1	5/8	725132	2.43
A6	3/4	1-1/8	725106	3.22	A33	1	1/2	725133	2.33
A11	7/8	2	725111	4.33	A34	1-1/2	3/8	725134	3.08
A12	11/16	1-1/4	725112	3.22	A35	1	3/8	725135	2.26
A13	1-1/8	1-1/8	725113	3.83	A36	1-5/8	3/8	725136	3.40
A14	11/16	7/8	725114	2.33	A37	1-1/4	1/4	725137	2.58
A15	1/4	1-1/16	725115	3.06	A38	1	1	725138	2.41
A21	1	1	725121	2.73	A39	3/4	3/4	725139	1.92
A22	3/4	5/8	725122	2.38	A40	3/4	-	725140	2.38
A23	3/4	1	725123	2.43					

ASK FOR MORE DETAILS OR GO TO: <https://kar.ca/abrasives-files-grinding/mounted-point/a-shape.html>



SPRING INTO SAVINGS

25% OFF ALL MOUNTED FLAP WHEELS

Mounted Flap Wheels



1/4" Shank with a variety of grits available – 40, 60, 80, 120, 150, 180, 240, & 320



Dimensions	Price	Dimensions	Price	Dimensions	Price
3/4 x 3/4	5 ²⁹ /ea.	2 x 3/8	5 ⁵⁰ /ea.	2-1/2 x 1	8 ³¹ /ea.
1 x 1	5 ⁵⁰ /ea.	2 x 1/2	5 ⁹³ /ea.	2-1/2 x 1-1/2	10 ²⁵ /ea.
1-3/16 x 3/16	5 ⁰⁸ /ea.	2 x 5/8	6 ³⁷ /ea.	3 x 1/2	7 ⁷⁷ /ea.
1-3/16 x 3/8	5 ¹⁸ /ea.	2 x 3/4	6 ³⁷ /ea.	3 x 3/4	7 ⁸⁸ /ea.
1-1/2 x 1/2	5 ³⁹ /ea.	2 x 1	7 ⁰² /ea.	3 x 1	10 ³⁵ /ea.
1-1/2 x 5/8	5 ³⁹ /ea.	2 x 1-1/2	8 ³¹ /ea.	3 x 1-1/2	12 ⁸³ /ea.
1-1/2 x 3/4	5 ⁵⁰ /ea.	2-1/2 x 1/2	6 ¹⁵ /ea.	3 x 2	14 ⁸⁷ /ea.
1-1/2 x 1	5 ⁸³ /ea.	2-1/2 x 3/4	7 ³⁴ /ea.		

Dimensions: Inch | Diameter x Length

ASK FOR MORE DETAILS OR GO TO: <https://kar.ca/catalogsearch/result/index/?p=1&q=Flexkraft+Flap>

ER Collet Chucks

CAT40 & CAT50



- Constructed of high quality alloy steel - SAE8620/20MnCR5
- Taper to taper runoff: <0.0002"
- Coolant through spindle
- CAT40 balanced G2.5@20,000 RPM
- CAT50 balanced G6.3@15,000 RPM
- Balanced tools supplied with QA certificates
- Supplied with depth set screws
- Supplied with high torque hard coat power nuts
- Taper shank ground to AT3 accuracy or better
- DIN AD+B flange coolant

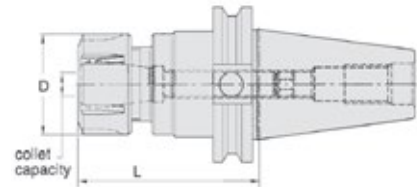

NOTE: Collet wrench sold separately

NEW LOWER PRICES

Collet Series	Collet Cap Min-Max (Inch)	Nut	D (Inch)	L (Inch)	CAT40			CAT50		
					Weight (lbs)	Code	Price	Weight (lbs)	Code	Price
ER11	0.02-0.28	Hex	0.79	2.50	2.0	300681	89 ⁹⁹	-	-	-
	0.02-0.28		0.79	4.00	2.2	300682	94 ⁹⁹	-	-	-
	0.02-0.28		0.79	6.00	2.4	300683	104 ⁵⁰	-	-	-
ER16	0.02-0.41		1.10	2.50	2.4	310965	89 ⁹⁹	-	-	-
	0.02-0.41		1.10	4.00	3.2	310966	94 ⁹⁹	7.3	312054	134 ⁹⁹
	0.02-0.41		1.10	5.00	3.2	310967	104 ⁵⁰	-	-	-
ER20	0.02-0.41		1.10	6.00	-	-	-	7.9	312055	154 ⁹⁹
	0.02-0.50		1.34	2.50	2.4	310968	89 ⁹⁹	-	-	-
	0.02-0.50		1.34	4.00	3.5	310969	94 ⁹⁹	7.4	312056	134 ⁹⁹
ER25	0.02-0.50		1.34	6.00	3.7	310970	104 ⁵⁰	8.1	312057	154 ⁹⁹
	0.04-0.63	1.65	2.50	2.6	310971	89 ⁹⁹	-	-	-	
	0.04-0.63	1.65	4.00	4.5	310972	94 ⁹⁹	7.8	312058	134 ⁹⁹	
ER32	0.04-0.63	1.65	6.00	4.4	310973	104 ⁵⁰	8.8	312059	154 ⁹⁹	
	0.04-0.81	1.97	2.75	2.6	310974	89 ⁹⁹	-	-	-	
	0.04-0.81	1.97	4.00	6.8	310975	94 ⁹⁹	8.1	312060	134 ⁹⁹	
ER40	0.04-0.81	1.97	6.00	4.4	310976	104 ⁵⁰	9.5	312061	154 ⁹⁹	
	0.12-1.00	2.48	3.00	3.0	310977	89 ⁹⁹	-	-	-	
	0.12-1.00	2.48	4.00	-	-	-	8.9	312062	134 ⁹⁹	
	0.12-1.00	2.48	6.00	3.0	310978	104 ⁵⁰	11.8	312063	154 ⁹⁹	



Sharpening Stones

Aluminum Oxide & Silicon Carbide

- Coarse 120 grit and fine 150 grit in one
- Size: 1" x 2" x 6"



7.99/ea.

Aluminum Oxide Code 604230
Silicon Carbide..... Code 604231

Universal Lathe Chucks

Cast Iron – 2-Piece Jaws – 3-Jaw Self-Centering



Type D – Series 3245

- Cast iron
- Direct mount
- Ground working surfaces

Standard Accessories:

- 1 set of hard top jaws
- 1 set of hard master jaws
- 1 wrench



Chuck Size (Inch)	Weight (lbs)	Code	Price
5	11.02	355023	1762.13
6	19.84	355024	1154.22
6	19.84	355025	1156.49
6	19.84	355026	
8	41.89	355027	
8	41.89	355028	1402.21 /ea.
8	41.89	355029	
8	41.89	355030	
10	70.55	355031	1901.28 /ea.
10	70.55	355032	

WWW.KAR.CA FOR ALL DIMENSIONS: <https://tinyurl.com/4krhr4>

UP TO 25" UNIVERSAL CHUCKS AVAILABLE
MORE DETAILS AT WWW.KAR.CA

Live Centers

Value-Turn®

WHILE QUANTITIES LAST



- A sturdy low-cost center designed for general medium-duty turning applications
- ±0.00005" total indicator runout guaranteed
- Precision three-bearing design enables live center to achieve high RPM's and solid load ratings
- Head is hardened for strength and durability



MT3 Value-Turn® Code 826259 387.87
MT4 Value-Turn® Code 826260 469.71
MT5 Value-Turn® Code 826261 527.84

MORE DETAILS: <https://tinyurl.com/2cun6dkc>

Dead Blow Hammers

Steel construction with steel shot



- One piece steel construction with steel shot
- Polyurethane coated thermoplastic rubber – no exposed metal on head or handle
- Textured non-slip handle with flanged end for a comfortable and safe grip
- Hammer hardness: 90A-95A

18 oz. Code 284560 22.51
24 oz. Code 284561 25.23
33 oz. Code 284562 31.49
41 oz. Code 284563 36.01
49 oz. Code 284564 42.55

Drill Press Vises



3" x 2-3/4" Code 327490 40.39
4" x 3-3/4" Code 327491 51.54
5" x 4-5/8" Code 327492 92.08
6" x 5-5/8" Code 327493 113.10

Semi-Universal Dividing Heads

With Tail Stock & Dividing Plates



189 x 100mm (7.5" x 4")
D-05 BS-0
Code 277070 854.40
293 x 128mm (11.5" x 5")
D-06 BS-1
Code 277072 1108.88

- A simplified type of universal index center
- Can be used for either direct or indirect dividing
- Three additional indexing plates included to provide the ability of indirect dividing of all divisions from 2 to 50 and also most common divisions up to 380
- Hardened and ground spindle is rigidly held in a taper roller bearing
- Hardened and ground worm
- Swivel head can be locked on any angle from 10° below horizontal to 90° vertical - precision fitting to base allows smooth rotation
- Threaded spindle nose and 24 hole dividing plate with easy conversion to fast direct indexing on numbers 2, 3, 4, 6, 8, 12 and 24

MORE DETAILS: <https://kar.ca/catalogsearch/result/?q=277070+277072>

INSIZE TOOLS THAT MEASURE UP

Electronic Calipers

Miniature



- Resolution: 0.0005"/0.01mm
- Accuracy: ±0.0010"
- Buttons: zero, on/off, inch/mm
- Auto power off
- Battery LR44
- Stainless steel
- Supplied in fitted storage case

0-3"/0-75mm
Code 280019

66.89

0-4"/0-100mm
Code 280020

65.64

Absolute

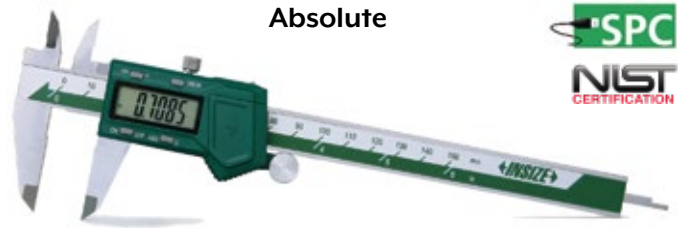

- Absolute system
- Resolution: 0.0005"/0.01mm
- Buttons: Inch/mm, ABS/REL, on/off, origin set
- Battery CR2032
- Auto power off
- Data output
- Stainless steel
- Supplied in fitted storage case

OPTIONAL ACCESSORY: SPC cable

0-6"/0-150mm
Code 285127

120.76

0-8"/0-200mm
Code 285128

152.47

0-12"/0-300mm
Code 285129

198.40

EXCLUSIVELY AVAILABLE FROM KAR IN CANADA: <https://kar.ca/catalogsearch/result/?q=INSIZE>

Punch Sets

Transfer Punch Sets

- Overall length: 4-7/8"
- All sets in metal indexed storage case

28 punches
3/32 to 1/2" x 1/64"
plus 17/32"
Code 415090

26.99

25 punches
1 to 13mm x 0.5mm
Code 415100

27.99



Pin Punch Set

- Overall length: 4"
- 1/16 (1.5), 3/32 (2.5), 1/8 (3), 5/32 (4), 3/16 (5), 7/32 (5.5), 1/4 (6), and 5/16 (8)
- Hardened and tempered
- Supplied in storage case



8 punches
Code 460041

17.49

WHILE
QUANTITIES
LAST

Center Punch Set

- 1/16" diameter
- 4" length
- Point size: 1/8, 3/6, 1/4, 5/16, and 3/8
- Tool steel with black oxide finish, hardened and tempered on both ends
- Knurled finger grip



5 punches
Code 283977

8.46

WHILE
QUANTITIES
LAST

BLOWOUT PRICES

Machine Lamps

Universal Waterproof & Halogen

WHILE
QUANTITIES
LAST



- 50W halogen lamp
- Waterproof
- 120V connection (6ft cord)
- Handle on head allows easy positioning
- 24V

UNIVERSAL WITH TRANSFORMER (in base)

JW 55RTS - ShortCode 302961 | **121.64**

UNIVERSAL WITHOUT TRANSFORMER
(for connection to machines)

JW 55RS - ShortCode 302942 | **85.04**

HALOGEN WITH TRANSFORMER (in base)

JH 20RTS - ShortCode 302962 | **77.49**

JH 20RTM - 18 (9+9)Code 302963 | **76.45**

JH 20RTL - 32 (16+16)Code 302964 | **87.00**

- 20W halogen lamp
- Vibration resistant
- 120V connection (6 ft. cord)
- Articulating arm

HALOGEN WITHOUT TRANSFORMER
(for connection to machines)

JH 20RS - ShortCode 302945 | **60.22**

JH 20RM - 18 (9+9)Code 302946 | **70.28**

JH 20RL - 32 (16+16)Code 302947 | **73.61**

KAR INDUSTRIAL INC.

www.kar.ca

Toronto: 1-800-387-3127
Montréal: 1-800-363-7862
Edmonton: 1-866-440-4326

Code 000307

Offer valid until June 30, 2021

*Products shown may not be exactly as illustrated

FIND DISTRIBUTOR

MAKING IT EASY TO DO BUSINESS WITH SINCE 1954... CONTACT YOUR LOCAL KAR DISTRIBUTOR TODAY!