



Skoda Heavy Duty Live Centres - CSN 243324/CSN 243324M

Features

- The rotating spindle is extended right through the tapered shank
- Two specially designed adjustable needle-roller bearings carry all radial loads
- A heavy duty ball thrust bearing takes all axial thrust
- Complete protection of bearings from the ingress of coolant, dirt or swarf is provided by the built-in oil-seal, which also prevents loss of lubricant



Morse Taper	Maximum RPM	Weight of Work Piece	SKODA Code No.	Reg. Price \$	SALE \$
1	6,000	200 lb	310105	185.19	114.82
2	6,000	750 lb	310110	278.33	172.56
3	5,000	880 lb	310115	331.54	205.55
4	4,000	2860 lb	310120	421.56	261.37
5	3,500	4400 lb	310125	608.39	377.20
6	2,500	8800 lb	310130	1003.55	622.20

Fast Drill Re-Sharpener



Starting At

\$1312⁰⁶

See page 3

Premium HSS Jobber Length Drills



Starting At

\$1⁸⁶

See page 2

GS-ADX-160G Precision Milling Machine Vise



NEW AND IMPROVED

\$716²²

See page 9

Outside Micrometers

Individual & Sets

ASIMETO



Starting At **\$35⁰¹**

See page 6

Warehouse Overstock

Wide Range Of Products Marked Down To Move



See pages 10-11

TABLE OF CONTENTS

Cutting Tools..... Pages 2-4

Abrasives..... Page 5

Shop Supplies..... Page 5

Precision Tools..... Pages 6-7

Machine Tool Accessories..... Pages 7-9

Warehouse Overstock..... Pages 10-11

Shrink Fit Tooling..... Page 12

Square Tool Bits



Square Size	Overall Length (in.)	HSS Code No.	Reg Price \$	SALE \$	5% Cobalt Code No.	Reg Price \$	SALE \$
1/8	2-1/2	159002	4.24	3.39	160103	7.14	5.71
3/16	2-1/2	159004	10.76	8.61	160105	12.60	10.08
1/4	2-1/2	159006	11.39	9.11	160110	14.10	11.28
5/16	2-1/2	159008	12.21	9.77	160115	16.50	13.20
5/16	3	159010	13.46	10.77	160117	17.80	14.24
3/8	3	159012	17.28	13.82	160120	19.30	15.44
7/16	4	159014	13.66	10.93			
1/4	4	159016	15.11	12.09	160127	18.94	15.15
1/2	4	159018	27.32	21.86	160130	33.70	26.96
5/8	5	159020	30.02	24.02	160135	62.20	49.76
3/4	5	159022	58.58	46.86	160140	90.70	72.56
1/4	6	159024	22.77	18.22	-	-	-
5/16	6	159026	23.60	18.88	-	-	-
3/8	6	159028	31.57	25.26	-	-	-
1/2	6	159030	40.47	32.38	-	-	-

Premium HSS Jobber Length Drills

These Premium HSS drills can be used in a variety of applications. Their surface treatment increases abrasion resistance, which reduces the amount of chip welding and improves chip flow.

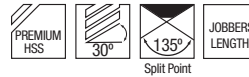

Size	Decimal Equivalent	Flute Length	Overall Length	Code No.	Reg. Price \$	SALE \$
1/8"	0.1250"	1-5/8"	2-3/4"	128005	2.48	1.86
3/16"	0.1875"	2-5/16"	3-1/2"	128009	2.90	2.18
13/64"	0.2031"	2-7/16"	3-5/8"	128010	3.21	2.41
1/4"	0.2500"	2-3/4"	4"	128013	4.24	3.18
17/64"	0.2656"	2-7/8"	4-1/8"	128014	5.38	4.04
3/8"	0.3750"	3-5/8"	5"	128021	9.21	6.91
1/2"	0.5000"	4-1/2"	6"	128029	15.94	11.96

29pc Set 1/16 - 1/2" x 64ths Fractional Set 128119 217.20 **162.90**

Full size range on promotion. See page B11 of our Catalogue

Noga The Set - SP7700

The most popular deburring tools you need to carry for any deburring application. Packed in one handy box.



Contains:
Countersink NG3100, Mini Scraper NG3700, Noga V Cut NG3200, Adjustable Scraper SC8000, Keyway-Burr NG3300, Internal Scraper NG3710, Super Burr NG3003



Model	Code No.	Reg. Price \$	SALE \$
SP7700	165482	223.25	178.60

NC/CNC Spotting Drills HSS

These drills are used for perfect alignment of the follow-on tool.

- Standard length
- 90° point
- Right hand cut
- 120° point



Size (in.)	Decimal Equiv. (in.)	Overall Length (in.)	90° Flute Length	HSS Code No.	Reg Price \$	SALE Price \$	120° Flute Length	HSS Code No.	Reg Price \$	SALE \$
1/4	0.2500	2-1/2	3/4	116346	33.74	26.99	21/32	116352	34.16	27.33
3/8	0.3750	3-1/8	1-1/8	116347	36.23	28.98	1	116353	36.85	29.48
1/2	0.5000	3-3/4	1-3/8	116348	46.47	37.18	1-3/16	116354	47.09	37.67
5/8	0.6250	4-3/8	1-5/8	116349	61.38	49.10	1-15/32	116355	60.86	48.69
3/4	0.7500	5	1-7/8	116350	77.42	61.94	-	-	-	-

Taper Length Drills - Fractional Sizes

Taper length drills are designed for general purpose drilling where longer length is required.



Size (in.)	Decimal Equiv. (in.)	Flute Length	Overall Length	HSS Code No.	Reg. Price \$	SALE \$
1/64	0.0156	5/16	1-1/2	116792	9.63	7.70
1/32	0.0312	3/4	2	116793	7.66	6.13
3/64	0.0469	1-1/8	2-1/4	116794	3.62	2.90
1/16	0.0625	1-3/4	3	116795	3.83	3.06
5/64	0.0781	2	3-3/4	116796	5.28	4.22
3/32	0.0938	2-1/4	4-1/4	116797	5.38	4.30
7/64	0.1094	2-1/2	4-5/8	116798	6.62	5.30
1/8	0.1250	2-3/4	5-1/8	116799	6.73	5.38
9/64	0.1406	3	5-3/8	116800	9.00	7.20
5/32	0.1562	3	5-3/8	116801	8.18	6.54
11/64	0.1719	3-3/8	5-3/4	116802	9.63	7.70
3/16	0.1875	3-3/8	5-3/4	116803	8.18	6.54
13/64	0.2031	3-5/8	6	116804	10.97	8.78
7/32	0.2188	3-5/8	6	116805	11.70	9.36

Full size range on promotion. See page B26 of our Catalogue

CUTTING TOOLS



2 Flute Regular Length Carbide End Mills



A general purpose carbide end mill with maximum chip clearance added.

For: End Milling Slotting Sinking

On: Variety of Steels, Cast Iron, Non-Ferrous metals, Plastics, Abrasive type materials



Cutting Dia.	Shank Dia.	Flute Length	Overall Length	Bright Code No.	Reg. Price \$	SALE \$	TiAlN Code No.	Reg. Price \$	SALE \$
1/32	1/8	1/8	1-1/2	103770	12.97	10.38	102677	16.09	12.87
3/64	1/8	9/64	1-1/2	103772	12.97	10.38	102799	16.09	12.87
1/16	1/8	3/16	1-1/2	103848	12.03	9.62	102800	15.16	12.13
5/64	1/8	1/4	1-1/2	103773	12.03	9.62	102801	15.16	12.13
3/32	1/8	5/16	1-1/2	103849	11.38	9.10	102802	14.50	11.60
7/64	1/8	3/8	1-1/2	-	-	-	102803	14.50	11.60
1/8	1/8	1/2	1-1/2	103850	10.51	8.41	102804	13.62	10.90
9/64	3/16	1/2	2	103776	15.52	12.42	-	-	-
5/32	3/16	9/16	2	103851	15.52	12.42	102806	18.64	14.91
11/64	3/16	9/16	2	103777	15.52	12.42	102807	18.64	14.91
3/16	3/16	5/8	2	103852	14.73	11.78	-	-	-
7/32	1/4	5/8	2-1/2	103853	19.51	15.61	102811	25.97	20.78
1/4	1/4	3/4	2-1/2	103854	17.75	14.20	102810	24.20	19.36
9/32	5/16	3/4	2-1/2	103855	31.14	24.91	102813	40.79	32.63
5/16	5/16	13/16	2-1/2	103856	24.91	19.93	102812	34.55	27.64
11/32	3/8	7/8	2-1/2	103779	36.90	29.52	-	-	-
3/8	3/8	1	2-1/2	103857	31.03	24.82	102814	40.65	32.52
13/32	7/16	1	2-3/4	103780	44.12	35.30	-	-	-
7/16	7/16	1	2-3/4	103858	37.85	30.28	102816	48.83	39.06
1/2	1/2	1	3	103859	49.69	39.75	102818	60.65	48.52
9/16	9/16	1-1/8	3-1/2	103886	84.88	67.90	102820	100.71	80.57
5/8	5/8	1-1/4	3-1/2	103887	95.81	76.65	102822	111.68	89.34
11/16	3/4	1-3/8	4	103888	159.57	127.66	102824	178.28	142.62
3/4	3/4	1-1/2	4	103889	140.48	112.38	102826	159.20	127.36
7/8	7/8	1-1/2	4	103890	202.18	161.74	102828	229.80	183.84
1	1	1-1/2	4	103891	210.17	168.14	102830	237.78	190.22

4 Flute Regular Length Carbide End Mills



The industry standard. Wear resistance and minimal deflection for excellent size control.

For: Slotting, Production Milling, Profiling

On: Variety of Steels



Cutting Dia.	Shank Dia.	Flute Length	Overall Length	Bright Code No.	Reg. Price \$	SALE \$	TiAlN Code No.	Reg. Price \$	SALE \$
1/32	1/8	1/8	1-1/2	103781	12.97	10.38	102899	16.09	12.87
3/64	1/8	9/64	1-1/2	103782	12.97	10.38	102831	16.09	12.87
1/16	1/8	3/16	1-1/2	103870	12.03	9.62	102832	15.16	12.13
5/64	1/8	1/4	1-1/2	103783	12.03	9.62	102833	15.16	12.13
3/32	1/8	5/16	1-1/2	103871	11.38	9.10	102834	14.50	11.60
7/64	1/8	3/8	1-1/2	103784	11.38	9.10	102835	14.50	11.60
1/8	1/8	1/2	1-1/2	103860	10.51	8.41	102836	13.62	10.90
9/64	3/16	1/2	2	103785	15.52	12.42	102837	18.64	14.91
5/32	3/16	9/16	2	103861	15.52	12.42	102839	18.64	14.91
11/64	3/16	9/16	2	103786	15.52	12.42	102841	18.64	14.91
3/16	3/16	5/8	2	103862	14.73	11.78	102838	17.84	14.27
13/64	1/4	5/8	2-1/2	103787	19.51	15.61	102843	25.97	20.78
7/32	1/4	5/8	2-1/2	103863	19.51	15.61	102845	25.97	20.78
1/4	1/4	3/4	2-1/2	103864	17.75	14.20	102840	24.20	19.36
9/32	5/16	3/4	2-1/2	103865	31.14	24.91	102847	40.79	32.63
5/16	5/16	13/16	2-1/2	103866	24.91	19.93	102842	34.55	27.64
11/32	3/8	7/8	2-1/2	103789	36.90	29.52	102849	46.53	37.22
3/8	3/8	1	2-1/2	103867	31.03	24.82	102844	40.65	32.52
13/32	7/16	1	2-3/4	103790	44.12	35.30	102851	55.08	44.06
7/16	7/16	1	2-3/4	103868	37.85	30.28	102846	48.83	39.06
1/2	1/2	1	3	103869	49.69	39.75	102848	60.65	48.52
9/16	9/16	1-1/8	3-1/2	103933	84.88	67.90	102850	100.71	80.57
5/8	5/8	1-1/4	3-1/2	103934	95.81	76.65	102852	111.68	89.34
11/16	3/4	1-3/8	4	103935	159.57	127.66	102854	178.28	142.62
3/4	3/4	1-1/2	4	103936	140.48	112.38	102856	159.20	127.36
7/8	7/8	1-1/2	4	103937	202.18	161.74	-	-	-
1	1	1-1/2	4	103938	210.17	168.14	102860	237.78	190.22

Fast Drill Re-Sharpener

Model DM213

Drill Diameter: Ø2mm - Ø13mm
 Point Angle: 85° ~ 140°
 R.P.M: 6000 rpm
 Weight: 10 kg

Standard Accessories

- ER20 Collets, ranged from 2.5mm-13mm (12pcs).
- CBN Diamond wheel #200x1pc (for High Speed drill).
- 4mm and 5mm hexagon wrench x 1 pc each.



Code No.: 326130
 Reg. Price: \$1543.60

\$1312.06

Model DM1226

Drill Diameter: Ø8mm - Ø30mm
 Point Angle: 85° ~ 140°
 R.P.M: 4000 rpm
 Weight: 25 kg

Standard Accessories

- ER 40 Collets, ranged from 12mm-26mm (15pcs).
 Optional Collets 8~11mm, 27~30mm
- CBN Diamond wheel #200x1pc (for High Speed drill).
- 4mm and 6mm hexagon wrench x 1 pc each.



Code No.: 326134
 Reg. Price: \$3533.80

\$3003.73

CUTTING TOOLS

Solid Carbide Double Cut Burrs



CYLINDRICAL-SQUARE END-END NOT CUT

E.D.P.	Cutter Dia. (in.)	Length of Cut (in.)	Shank Dia. (in.)	Overall Length (in.)	Double Cut Code No.	Reg. Price \$	SALE \$
SA-1	1/4	5/8	1/4	2	170014	16.25	13.81
SA-3	3/8	3/4	1/4	2-1/2	170022	21.74	18.48
SA-5	1/2	1	1/4	2-3/4	170026	34.26	29.12



CYLINDRICAL- END CUT

E.D.P.	Cutter Dia. (in.)	Length of Cut (in.)	Shank Dia. (in.)	Overall Length (in.)	Double Cut Code No.	Reg. Price \$	SALE \$
SB-12	1/8	5/8	1/4	2	170035	18.84	16.01
SB-1	1/4	5/8	1/4	2	170037	17.39	14.78
SB-5	1/2	1	1/4	2-3/4	170041	42.75	36.34
SB-6	5/8	1	1/4	2-3/4	170045	47.30	40.21



OVAL SHAPE

E.D.P.	Cutter Dia. (in.)	Length of Cut (in.)	Shank Dia. (in.)	Overall Length (in.)	Double Cut Code No.	Reg. Price \$	SALE \$
SE-41	1/8	7/32	1/8	1-1/2	170160	8.59	7.30
SE-3	3/8	5/8	1/4	2-3/8	170168	26.81	22.79
SE-6	5/8	1	1/4	2-3/4	170172	53.41	45.40



CYLINDRICAL- RADIUS END

E.D.P.	Cutter Dia. (in.)	Length of Cut (in.)	Shank Dia. (in.)	Overall Length (in.)	Double Cut Code No.	Reg. Price \$	SALE \$
SC-42	1/8	9/16	1/8	1-1/2	170052	8.59	7.30
SC-1	1/4	5/8	1/4	2	170060	18.22	15.49
SC-3	3/8	3/4	1/4	2-1/2	170066	24.12	20.50
SC-4	7/16	1	1/4	2-3/4	170068	35.09	29.83
SC-5	1/2	1	1/4	2-3/4	170070	37.88	32.20



TREE-RADIUS END

E.D.P.	Cutter Dia. (in.)	Length of Cut (in.)	Shank Dia. (in.)	Overall Length (in.)	Double Cut Code No.	Reg. Price \$	SALE \$
SF-1	1/4	5/8	1/4	2	170108	19.67	16.72
SF-51	1/4	1/2	1/8	2	170110	14.70	12.50
SF-3	3/8	3/4	1/4	2-1/2	170112	24.84	21.11
SF-5	1/2	1	1/4	2-3/4	170116	35.09	29.83



BALL SHAPE

E.D.P.	Cutter Dia. (in.)	Length of Cut (in.)	Shank Dia. (in.)	Overall Length (in.)	Double Cut Code No.	Reg. Price \$	SALE \$
SD-42	1/8	-	1/8	1-1/2	170202	8.59	7.30
SD-14	3/16	-	1/4	2	170206	20.70	17.60
SD-51	1/4	-	1/8	2	170212	14.70	12.50
SD-5	1/2	-	1/4	2-1/4	170218	27.74	23.58
SD-6	5/8	-	1/4	2-3/8	170220	34.57	29.38



8PC SOLID CARBIDE DOUBLE CUT BURR SETS

- Solid carbide
- Double cut
- Comes in fitted case



Shank Contents	Shank	Code No.	Reg. Price \$	SALE \$
SA-51, SB-51, SC-51, SD-1, SD-52, SF-53, SG-51, SL-51	1/8"	172984	156.08	109.26
SA-3, SA-5, SC-1, SC-3, SD-3, SD-5 SF-3, SF-5	1/4"	172986	287.11	200.98

6" O.A.L. CARBIDE BURRS

E.D.P.	Cutter Dia. (in.)	Length of Cut (in.)	Shank Dia. (in.)	Overall Length (in.)	Double Cut Code No.	Reg. Price \$	SALE \$
SF-5L6	1/2	1	1/4	6"	170379	63.34	53.84
SL-3L6	3/8	1-1/16	1/4	6"	170382	54.75	46.54



90° Cobalt 3 Flute Countersinks



- M35 Cobalt - Bright or TiN coated
- Wide flutes provide good chip evacuation
- Positive cut
- Constant profile aids regrinding of the tool
- Self-centering of the cutting mill (three bearing points) virtually eliminates vibration



Diameter	O.A.L.	Shank Diameter	Bright Code No.	Reg. Price \$	SALE \$	TiN Code No.	Reg. Price \$	SALE \$
1/4"	45mm	1/4"	121899	29.30	23.44	121857	38.40	30.72
5/16"	45mm	1/4"	121900	33.80	27.04	121858	44.60	35.68
3/8"	50mm	1/4"	121901	38.40	30.72			
1/2"	50mm	1/4"	121902	47.60	38.08	121862	59.80	47.84
5/8"	60mm	3/8"	121903	55.20	44.16	121863	70.50	56.40
3/4"	60mm	3/8"	121904	64.40	51.52	121864	81.20	64.96
1"	70mm	3/8"	121905	78.20	62.56	121867	96.50	77.20
7pc Set			-	-	-	121856	439.30	351.44

82° Cobalt 3 Flute Countersinks



- M35 Cobalt - Bright
- Wide flutes provide good chip evacuation
- Positive cut
- Constant profile aids regrinding of the tool
- Self-centering of the cutting mill (three bearing points) virtually eliminates vibration



Diameter	O.A.L.	Shank Diameter	Bright Code No.	Reg. Price \$	SALE \$
5/16"	45mm	1/4"	121876	33.80	27.04
3/8"	50mm	1/4"	121877	38.40	30.72
1/2"	50mm	1/4"	121878	47.60	38.08
5/8"	60mm	3/8"	121879	55.20	44.16
3/4"	60mm	3/8"	121880	64.40	51.52
1"	70mm	3/8"	121881	78.20	62.56
7pc Set			121861	345.90	276.72

Ceramic Shape B Saucer Type Grinding Wheel

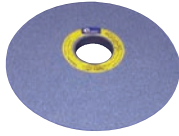
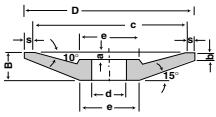

D	B	d	a	b	c	e	s	CSKG60K Code No.	Reg. Price \$	SALE \$
6	5/8	1-1/4	1/4	1/8	5-3/8	2	5/16	635095	76.80	61.44

1/4" Die Grinder - TP-9001

Specifications

- Air Inlet (N.P.T.): 1/4"
- Air Consumption (Loading): 13 cfm
- Exhaust System: Rear
- Aluminum Alloy Housing



Horse Power	RPM	Collet Size	Air Pressure (psi)	O.A.L. (in.)	Net Weight (lb)	Code No.	Reg. Price \$	SALE \$
0.9	18,000	1/4"(6mm)	90	7-5/16"	1.56	174052	217.10	151.97

5" Extended H.D. Die Grinder - TP-1104

Specifications

- Air Inlet (N.P.T.): 1/4"
- Air Consumption (Loading): 13 cfm
- Exhaust System: Rear
- Aluminum Alloy Housing



Horse Power	RPM	Collet Size	Air Pressure (psi)	O.A.L. (in.)	Net Weight (lb)	Code No.	Reg. Price \$	SALE \$
0.3	25,000	1/4"(6mm)	90	11-1/4"	1.45	174032	252.70	176.89

Air Micro Die Grinder

Contains:

- 1 pc. TP-501-1 Grinder
- 1 pc. 3 mm collet
- 10 pcs. 1/8" (3 mm) grinding stones
- 2 pcs. spanners
- 1 pc. blow case



Description	Code No.	Reg. Price \$	SALE \$
1/8" die grinder kit	174002	234.90	164.43

Pot Magnets

Unique combination of a strong magnet with nickel chrome plated insulating ring gives these magnets the superior holding power of larger ones

- 1/4"-20 threaded



Model	Diameter (in.)	Height (in.)	Magnetic Pull (kg)	Code No.	Reg. Price \$	SALE \$
PMG/11-16	11/16"	5/8"	2.7	231420	9.99	6.99
PMG/13-16	13/16"	3/4"	4.5	231422	12.56	8.79
PMG/1-1-16	1-1/16"	1"	6.0	231424	19.95	13.97
PMG/1-3-8	1-3/8"	1-3/16"	13	231426	28.85	20.20

10 Piece Needle File Set

Description	Code No.	Reg. Price \$	SALE \$
10 Piece Needle File Set	200761	10.00	8.00



10 Piece Diamond File Set

Description	Code No.	Reg. Price \$	SALE \$
10 Piece Diamond File Set	200763	15.90	12.72



Engineers Black Book - 3rd Edition

The all new 3rd Edition has been released with 40% more page content.

Full Colour - Pocket Sized - Lay Flat Format - Highly Durable - Anti-Glare

Easy to use **Pocket Book** contains a wealth of up to date, useful, practical, and hard to find information.

- Tables
- Grind Wheels
- Bolts & Nuts
- Tapers
- Tapping Drill Sizes
- Tolerances
- Spur Gear Calculations
- Hardening and Tempering
- Sharpening Information
- Illustrations
- Lubricants-Coolants
- Plastics
- Weights of Metals
- Equivalent Charts
- Tungsten Carbide
- Standards
- Conversion Factors
- Formulae
- Keys and Keyways
- Speeds and Feeds
- G Codes
- Engineering Drawing Standards
- Geometrical Construction
- Free set of self-adhesive bookmarking tabs included

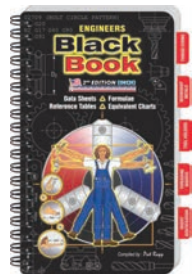

Code No.: 180151
Reg. Price: \$61.10

\$51.94

Fastener Black Book

- Inch
- ISO & DIN Specifications
- Fastener Platings & Finishes
- Pre-Loads & Tightening Torques
- Thread Terminology & Classifications
- Standard Grades, Tolerances & Markings
- Thread Forms, Heads, Points, Materials and Coatings

Includes a Free Thread Gauge!

Code No.: 180156
Reg. Price: \$53.80

\$45.73

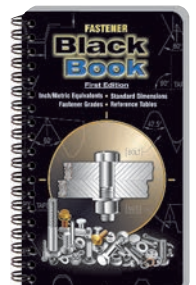

IP67 Coolant Proof Digital Calipers

ASIMETO

Features:

- Absolute function, there is no need to set the zero
- Hold function for easy reading
- Absolute or incremental measuring modes
- Inch/Metric conversion
- Metal Housing, the design will allow the caliper to be used in normal workshop conditions and is resistant to coolant, water, dust or oil
- Auto power on/off
- Power: 3V lithium battery



Range	Resolution	Accuracy	Code No.	Reg. Price \$	SALE \$
0-6" / 0-150mm	0.0005" / 0.01mm	±.001"	7305062	221.23	165.92
0-8" / 0-200mm	0.0005" / 0.01mm	±.0015"	7305082	339.04	254.28
0-12" / 0-300mm	0.0005" / 0.01mm	±.0015"	7305122	408.27	306.20

Thread Measuring Wire Set

ASIMETO

Features:

- 48 wires - 16 different sizes
- Measures all threads from 3 - 48 threads per inch
- Measures all metric threads from 0.5mm to 6mm
- Also measures ACME threads
- Laminated chart included



Description	Code No.	Reg. Price \$	SALE Price \$
Thread Wire Set	7697300	28.95	21.71

Articulating Arm Magnetic Bases

ASIMETO

Features:

- Accepts test indicators with dovetail clamping mechanism
- Dial gauges can be held by the 3/8" or 8mm diameter stem or by the lug backing plate
- Arm has 3 articulating joints that can be locked with the single hand knob
- The rotary knob switches natural magnet on or off
- The precision surfaces and the bottom V are securely fastened to the ferrous work piece or machine table when the rotary knob is in the on position
- Slot: 6.5mm
- Working Angle 150°
- 7602011 does not have fine adjustment



Magnetic Power	Magnetic Base (L x W x H)	Height	Type	Code No.	Reg. Price \$	SALE \$
30 kg	36 x 30 x 35mm	195mm	I	7602011	61.16	45.87
80 kg	60 x 50 x 55mm	350mm	II	7602021	147.70	110.78
80 kg	60 x 50 x 55mm	440mm	III	7602031	194.27	145.70

IP65 Digital Outside Micrometers w/ SPC

ASIMETO

Features:

- Resolution Digital: 0.00005" / 0.001mm
Scale: 0.0001"
- Dual Ratchet combines both the Ratchet Stop and Friction Thimble
- Protection level IP65
- Carbide tipped measuring faces
- Upon switch-on the display will read the actual absolute measuring position
- Automatic On/Off to maximize battery life
- Inch/Metric conversion
- Absolute or incremental measuring modes



Range	Accuracy	Code No.	Reg. Price \$	SALE \$
0-1"/0-25mm	±0.0001"/0.002mm	7105015	227.00	170.25
1-2"/25-50mm	±0.0002"/0.002mm	7105025	279.24	209.43
2-3"/50-75mm	±0.0002"/0.003mm	7105035	312.18	234.14

Outside Micrometers

ASIMETO

Features:

- Flatness: 0.000024" / 0.6µm
- Carbide tipped measuring faces
- Grey painted steel frame
- Graduation: 0.0001"
- Ratchet Stop

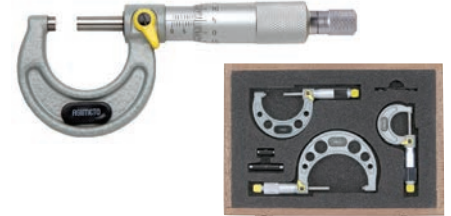

Range	Accuracy	Code No.	Reg. Price \$	SALE \$
0-1"	±0.0001"	7101013	46.68	35.01
1-2"	±0.0002"	7101023	52.03	39.02
2-3"	±0.0002"	7101033	57.90	43.43

SETS

Range	Code No.	Reg. Price \$	SALE \$
0-3"	7101637	136.79	102.59
0-6"	7101667	456.42	342.32

AGD2 Dial Indicators

ASIMETO

Features:

- Dial face dia.: 2.20" / 58mm
- Internal tolerance marker
- Flat back (attached) and lug back supplied
- With counter pointer
- Dial Reading: 0-100
- Range/Rev: 0.1"
- Accuracy: ±0.002"



Range	Graduation	Code No.	Reg. Price \$	SALE \$
0-1"	0.001"	7402261	43.22	32.42
0-1"	0.001"	7402263	52.03	39.02
0-1"	0.0005"	7402265	52.03	39.02
0-2"	0.001"	7402511	100.39	75.29

Double Beam Digit Counter Height Gauges

Features:

- Graduation: Inch: 0.001"/Metric: 0.01mm
- Dial & digit counter reading
- Hand wheel for easier travel
- Carbide tipped scriber
- The digit counter provides bi-directional positioning and the capability of setting zero at any position



ASIMETO

Range	Dial Grad.	Counter Grad.	Accuracy	Code No.	Reg. Price \$	SALE \$
Inch						
0-18"	0.001"	0.1" (Dual Reading)	±0.002"	7623181	535.20	401.40
0-24"	0.001"	0.1" (Dual Reading)	±0.002"	7623241	800.39	600.29
Metric						
0-300mm	.01mm	1.0mm (Dual Reading)	±0.04mm	7623120	527.44	395.58
0-1000mm	.01mm	1.0mm (Dual Reading)	±0.07mm	7623400	4729.94	3547.46

Rectangular Gauge Block Sets - Inch

Features:

- Individual serial numbers on each block, regardless of grade
- A complete certificate of calibration traceable to the N.I.S.T showing the deviation of each block.
- All sets are supplied in deluxe fitted wooden case
- Mirror polished surfaces provide superior wringing characteristics.



ASIMETO

Blocks per Set	Blocks In Set	Former Grade	Former Grade	Code No.	Reg. Price \$	SALE \$
81	1 Block: 0.050"	0	(2)	7650010	1069.46	802.10
	10 Blocks: 0.1000"-0.1009" x 0.0001" steps					
	49 Blocks: 0.101"-0.149" x 0.001" steps					
	17 Blocks: 0.150"-0.950" x 0.050" steps					
36	4 Blocks: 1.000"-4.000" x 1.000" steps	AS-1	(3)	7650011	683.21	512.41
	1 Block: 0.050"					
	10 Blocks: 0.1000"-0.1009" x 0.0001" steps					
	9 Blocks: 0.101"-0.109" x 0.001" steps					
	9 Blocks: 0.110"-0.190" x 0.010" steps					
	4 Blocks: 0.200"-0.500" x 0.100" steps					
3	3 Blocks: 1,2,4"	AS-2	(B)	7650012	552.40	414.30
	1 Block: 0.050"					
0	10 Blocks: 0.1000"-0.1009" x 0.0001" steps	0	(2)	7650020	632.23	474.17
	9 Blocks: 0.101"-0.109" x 0.001" steps					
0	9 Blocks: 0.110"-0.190" x 0.010" steps	AS-1	(3)	7650021	471.00	353.25
	4 Blocks: 0.200"-0.500" x 0.100" steps					
0	3 Blocks: 1,2,4"	AS-2	(B)	7650022	354.46	265.85
	1 Block: 0.050"					

Multi-tasking 5-Axis Modular Vises



The MULTITASKING range of vises has been specially designed for 5-axis machines. Working on 5 sides of the workpiece, it allows the best optimization of the machining cycle. Thanks to the compact design this kind of vise can be installed on all machining centers. The use of GRIP jaws is strongly recommended with multitasking vises.

- Self-centering or eccentric
- Eccentric jaw adjustment in steps of 2mm
- Highest accuracy in positioning and alignment (±0.02mm) due to ground rack teeth on both the base and the fixed jaws
- Minimum deflection
- Solid, rigid construction and maximum clamping ratio to the total length
- Positioning through ground holes or keyways
- All case hardened to HRC60 for durability

Type 1 & 2



Type 3



Vise shown with riser

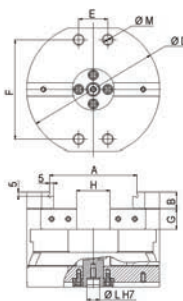

Type 1 & 2

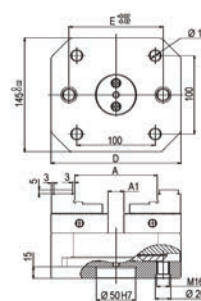

Type 3

	Type 1	Type 2	Type 3x166	Type 3x266
Code No.	382520	382522	382524	382526
Reg Price \$	2516.10	3354.70	3858.00	4025.80
SALE \$	2138.69	2851.50	3279.30	3421.93
A	74	104	108	208
A1	-	-	20	60
W	74	99	138	138
B	15	20	30	30
C	50	70	58	58
øD/D	120	160	166	266
E	5	35	120	200
F	92	120	-	-
G	20	25	-	-
H	20	40	-	-
øL H7	20	20	-	-
M	9	11	-	-
kg	4.9	11	13	20
kN	16	20	30	30

T-SLOT NUTS

Last thread incomplete to prevent stud from turning through bottom of nut into machine table.

- Case hardened
- Black oxide finish

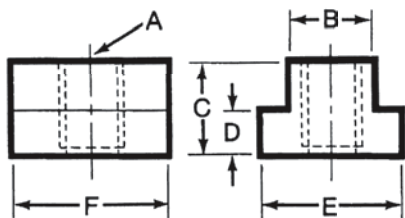
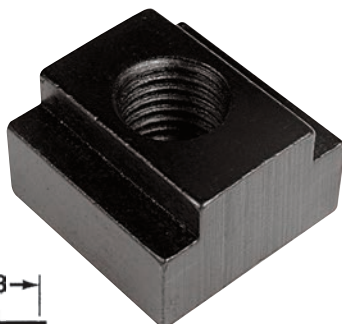

Inch

Model No.	Table Slot	Thread A	Te-Co Code No.	Reg. Price \$	SALE \$
373	5/16	1/4-20	607100	4.10	3.90
374	3/8	1/4-20	607102	4.20	3.99
375	3/8	5/16-18	607104	3.50	3.33
437	7/16	3/8-16	607106	3.50	3.33
500	1/2	3/8-16	607108	3.50	3.33
562	9/16	3/8-16	607110	4.00	3.80
502	1/2	7/16-14	607114	4.70	4.47
563	9/16	1/2-13	607116	3.90	3.71
625	5/8	1/2-13	607118	4.40	4.18
626	5/8	1/2-13	607120	5.90	5.61
687	11/16	1/2-13	607122	4.80	4.56
750	3/4	1/2-13	607124	6.50	6.18
688	11/16	5/8-11	607128	5.00	4.75
751	3/4	5/8-11	607130	5.30	5.04
812	13/16	5/8-11	607132	7.60	7.22
813	13/16	3/4-10	607134	8.40	7.98
875	7/8	3/4-10	607136	9.10	8.65
1000	1	3/4-10	607138	10.30	9.79
1000-34	1	3/4-10	607140	15.50	14.73
1010	1-1/16	3/4-10	607142	12.10	11.50
1001	1	7/8-9	607144	11.00	10.45
1125	1-1/8	7/8-9	607148	18.60	17.67
1063	1-1/16	1-8	607150	26.60	25.27
1126	1-1/8	1-8	607152	26.60	25.27
1250	1-1/4	1-8	607154	26.90	25.56

Metric

Model No.	Table Slot	Thread A (mm)	Te-Co Code No.	Reg. Price \$	SALE \$
61401	8	M6 x 1.0	608750	5.10	4.85
61402	10	M6 x 1.0	608751	5.90	5.61
61403	10	M8 x 1.25	608752	5.90	5.61
61404	12	M10 x 1.5	608753	5.90	5.61
61405	14	M10 x 1.5	608754	6.90	6.56
61406	14	M12 x 1.75	608755	6.90	6.56
61407	16	M12 x 1.75	608756	6.90	6.56
61408	17	M12 x 1.75	608757	8.30	7.89
61409	18	M16 x 2.0	608758	8.30	7.89
61410	21	M16 x 2.0	608759	9.10	8.65
61411	22	M20 x 2.5	608760	10.10	9.60
61412	27	M24 x 3.0	608761	14.80	14.06

GS Plain Base Modular Vises



Manufactured under rigid quality control. As a result of the high standard construction, GS Vises can be depended upon to maintain their accuracy under the most severe operating conditions. The modular design and the concept of interchangeability makes possible a wide variety of set up combinations.

Features/Benefits:

- High accuracy
- Unlimited clamping range
- High quality alloy steel
- High clamping pressure
- No jaw lift
- All vises are matched

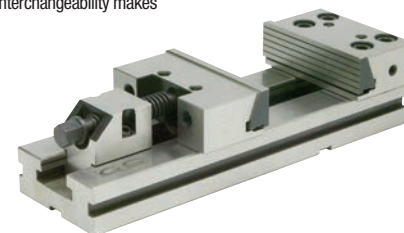

Model	Jaw Width (A)	Opening (C)	Jaw Height (B)	Code No.	Reg. Price \$	SALE \$
2	5	6	1.6	382010	1144.81	915.85
3	6	8	1.97	382015	1248.31	998.65
3	6	12	1.97	382017	1457.28	1165.82
4	7	8	2.4	382020	1771.71	1417.37
4	7	12	2.4	382025	1873.45	1498.76
4	7	16	2.4	382030	2082.42	1665.94
4	7	20	2.4	382032	2498.49	1998.79
5	8	12	2.6	382040	2709.22	2167.38
5	8	16	2.6	382045	3125.39	2500.31
5	8	20	2.6	382050	3750.43	3000.34
5	8	24	2.6	382052	4375.46	3500.37
6	12	24	3.2	382075	6461.51	5169.21

Standard ER Collets



Our ER collet system is made of special alloy steel material under excellent heat treatment and precise grinding process, so it has precise accuracy, powerful clamping ability, and is durable. This collet can clamp for a specific standard size and its next size. It can be widely used for boring, milling, drilling, and tapping as well as for grinding operation, and is available for all sizes.

- ER 16 collets collapse approximately 1/32" with full accuracy



ER 16 Collets

Size	Code No.	Reg. Price \$	SALE \$
1/16"	337531	41.25	28.88
1/8"	337533	30.60	21.42
3/16"	337535	30.60	21.42
1/4"	337537	30.60	21.42
5/16"	337540	30.60	21.42
3/8"	337542	30.60	21.42

ER 32 Collets

Size	Code No.	Reg. Price \$	SALE \$
1/8"	337703	35.93	25.15
1/4"	337708	35.93	25.15
3/8"	337713	35.93	25.15
1/2"	337718	35.93	25.15
5/8"	337723	35.93	25.15
3/4"	337727	35.93	25.15

Full size range on promotion. See page G25-31 of our Catalogue

5 Micron AA High Precision ER Collets



- Alloy Steel
- AA Collets have a runout of only 5 microns (0.005mm) compared to standard precision collets with up to 20 microns.



ER 16 Collets

Size	Code No.	Reg. Price \$	SALE \$
1/16"	336731	61.21	42.85
1/8"	336736	50.56	35.39
3/16"	336742	50.56	35.39
1/4"	336747	50.56	35.39
5/16"	336752	50.56	35.39
3/8"	336758	50.56	35.39

ER 32 Collets

Size	Code No.	Reg. Price \$	SALE \$
1/8"	336854	55.88	39.12
9/32"	336867	55.88	39.12
3/8"	336875	55.88	39.12
1/2"	336885	55.88	39.12
5/8"	336895	55.88	39.12
3/4"	336906	55.88	39.12

Full size range on promotion. Visit SowaTool.com

GS-ADX-160G Precision Milling Machine Vise



The GS-ADX-160G replaces our very popular 327290M vise.
It has been redesigned with new state-of-the-art workholding features.

NEW AND IMPROVED

- Jaw opening increased from 8.8" to 9.13"
- Same bed height as our 327290M: 2.875" ±0.0005"
- Narrower body style to allow more vises on a machine table
- The bearing pack has been relocated to help reduce oil / water / chip leakage into the vise body, thus improving the life time
- The thrust bearings have been replaced with ball bearings to make the pack stronger and more stable
- Same distance from the keyway to stationary as the 327290M
- ADX-160G weighs 68 lbs. vs. 80 lbs for the 327290M
- Spindle does not protrude past the end of the body
- Spherical segment creates all-directional alignment and reduces jaw lift for improved performance
- New brush seal design
- Perpendicularity (running face and jaw plate): 0.0004"
- Parallelism (running face to bottom of bed): 0.0006"
- Material: FCD-60 (80,000psi)
- New stationary jaw: 4 bolt stationary design reduces lift
- Pull-Type design: Reduces stress on body during clamping
- Chip evacuation: Straight through the body on sides and ends.
Locations strategically chosen to not reduce body strength

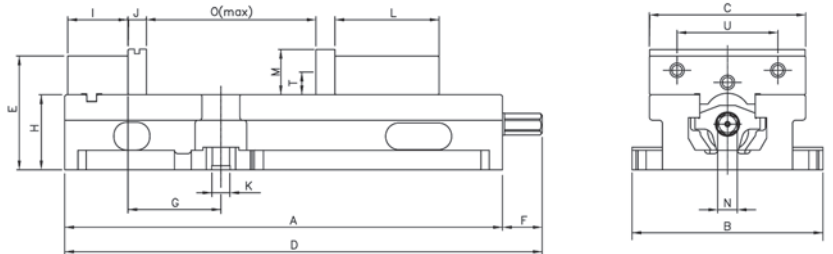
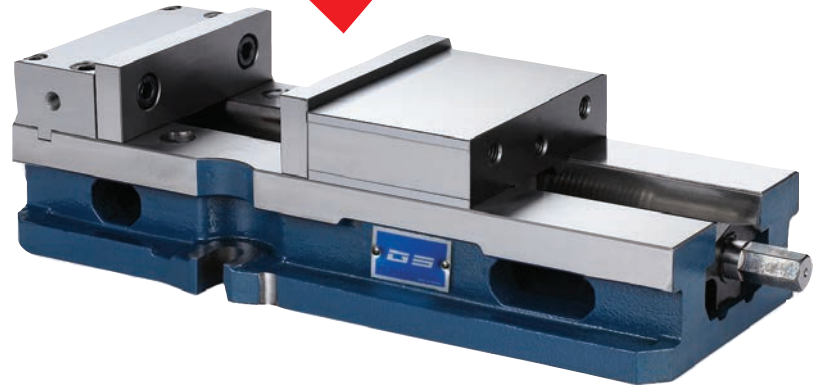

Code No.: 327320 **\$716.22**
Reg. Price: \$795.80

COMPARE	GS-ADX-160G DIMENSIONS																	mm/kg
	A	B	C	D	E	F	G	H	I	J	K	L	M	N	O	T	U	Weight
GS-ADX-160G	427	186	151	466	111.025	39	90.53	73.025	58.7	18.42	17.46	101.6	44.5	19	231	23.8	98.4	31kg
Competitor	427	187.73	151	466	110.74	39	91.74	73.025	58.7	18.42	16.66	101.6	44.07	19	230.6	23.9	98.4	35.5kg

GS High Performance Live Centres

- Each GS live centre uses either a 3, 4, or 5 bearing system providing superior performance and tool life
- A special coating process for the lip seal contact area offers a higher sealing ability and reduces rotational friction
- Designed to prevent excessive heat even when rotating at maximum RPM, extending tool life
- Every GS centre has passed at least 4 different accuracy tests to ensure the highest quality

NEW

CNC HIGH SPEED LIVE CENTRES



MT	Max RPM	Weight	Max Runout	Code No.	Reg. Price \$	SALE \$
2	5,000	1.54 lb	0.0001"	311011	358.43	304.67
3	5,000	1.73 lb	0.0001"	311012	436.07	370.66
4	3,800	4.06 lb	0.0001"	311013	498.83	424.01
5	3,000	9.30 lb	0.0001"	311014	723.47	614.95

INTERCHANGEABLE POINTS LIVE CENTRES

Every centre comes with "H" insert



MT	Max RPM	Weight	Max Runout	Code No.	Reg. Price \$	SALE \$
3	5,000	1.76 lb	0.0002"	311020	491.57	417.83
4	3,800	3.74 lb	0.0002"	311021	572.99	487.04
5	3,000	8.58 lb	0.0002"	311022	816.30	693.86



Call for other available points

Lever Type Oil Cans

This series of oil cans have a modern and contemporary design with a dome shaped body. Most popularly used oil can style all over the world. Manufactured with a steel pump, powder coated red body, and a flexible wire braided extension.



Model	Capacity	Spout Length	Code No.	Reg. Price \$	SALE \$
MP21F	200 ml	6"	231392	15.60	10.92
MP22F	300 ml	6"	231394	16.40	11.48

ANSI Inch Thread Plug Gauges

Features:

- Gold aluminum handles
- ANSI Standard

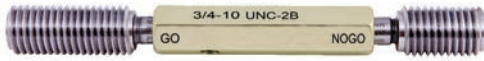

ASIMETO

Size	Double End Plug Gauge Code No.	Reg. Price \$	SALE \$
0 - 80	7695012	93.15	69.86
1 - 64	7695022	95.98	71.99
1 - 72	7695032	95.98	71.99
2 - 64	7695052	95.98	71.99
3 - 48	7695062	88.54	66.41
5 - 40	7695102	83.50	62.63
5 - 44	7695112	83.50	62.63
6 - 40	7695132	83.50	62.63
12 - 24	7695182	83.50	62.63
12 - 28	7695192	83.50	62.63
1/4 - 32	7695222	100.39	75.29
5/16 - 18	7695232	98.61	73.96
5/16 - 24	7695242	75.32	56.49
5-16 - 32	7695252	100.39	75.29
3/8 - 24	7695272	79.09	59.32
3/8 - 32	7695282	104.17	78.13
7/16 - 14	7695292	79.09	59.32
7/16 - 28	7695312	104.17	78.13
1/2 - 20	7695332	83.50	62.63
9/16 - 12	7695352	100.39	75.29
5/8 - 24	7695402	116.75	87.56
3/4 - 20	7695432	133.01	99.76
7/8 - 20	7695462	139.31	104.48

3pc Aviation Tin Snips Set

- Size: 245mm
- Chrome Vanadium Blade with polish
- Self opening action
- Left Cut, Straight Cut, Right Cut



Code No.: 505003

Reg. Price: \$43.00

\$32.25

Reinforced Depressed Center Discs For Steel

TAILIN

A. (Type 27)

- Approved by CNS standard No. 2551
- German DSA standard No. 2335

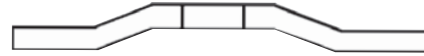

Dimensions	Specification	RPM	Code No.	Reg. Price \$	SALE \$
4 x 1/8 x 5/8"	A24R2G	15300	635600	2.40	1.80
4 x 1/8 x 5/8"	A24S2G	15300	635602	2.40	1.80
4 x 1/4 x 5/8"	A24R2G	15300	635604	2.70	2.03
4 x 1/4 x 5/8"	A24S2G	15300	635606	2.70	2.03
4-1/2 x 1/8 x 7/8"	A24R2G	13300	635608	3.50	2.63
4-1/2 x 1/8 x 7/8"	A24S2G	13300	635610	3.50	2.63
4-1/2 x 1/4 x 7/8"	A24S2G	13300	635612	3.80	2.85
7 x 1/8 x 7/8"	A24R2G	8500	635622	5.50	4.13
7 x 1/8 x 7/8"	A24S2G	8500	635624	5.50	4.13

Carbide Drill Mills

- Drill/Mills can be used for drilling, slotting, profile milling
- 2 Flute - 60° & 90° included point angle
- Made from submicron grain carbide
- Cutting diameter tolerance: +0.000/-0.002



Cutting Dia.	Shank Dia.	Flute Length	Overall Length	60° Code No.	Reg. Price \$	SALE Price \$	90° Code No.	Reg. Price \$	SALE \$
1/16"	1/8"	3/16"	1-1/2"	153187	13.47	12.12	153186	13.47	12.12
3/32"	1/8"	3/8"	1-1/2"	153189	13.47	12.12	153188	13.47	12.12
1/8"	1/8"	1/2"	1-1/2"	153191	13.47	12.12	153190	13.47	12.12
3/16"	3/16"	5/8"	2"	153193	17.75	15.98	153192	17.75	15.98
1/4"	1/4"	3/4"	2-1/2"	153195	22.05	19.85	153194	22.05	19.85
5/16"	5/16"	13/16"	2-1/2"	153197	28.91	26.02	153196	28.91	26.02
3/8"	3/8"	1"	2-1/2"	153199	35.38	31.84	153198	35.38	31.84
7/16"	7/16"	1"	2-3/4"	-	-	-	153200	43.55	39.20
1/2"	1/2"	1"	3"	153203	65.86	59.27	153202	65.86	59.27
5/8"	5/8"	1-1/4"	3-1/2"	153205	106.53	95.88	153204	106.53	95.88
3/4"	3/4"	1-1/2"	4"	153207	156.77	141.09	153206	156.77	141.09

HSS Straight Flute Chucking Reamers



For general purpose reaming of almost any metal, in drill presses, turret lathes or screw machines.

- Cutting ends are ground with a 45° chamfer for easy hole entry
- Built for machine use, with shorter, deeper flutes than hand reamers
- Right Hand Spiral
- Right Hand Cut
- H7 Tolerance



Flute Dia. (in.)	Decimal Equiv. (in.)	Flute Length	Overall Length	Code No.	Reg. Price \$	SALE \$
9/64	0.1460	1	4	110112	16.04	11.23
11/64	0.1719	1-1/8	4-1/2	110122	16.04	11.23
13/64	0.2031	1-1/4	5	110132	19.15	13.41
7/32	0.2187	1-1/4	5	110137	18.63	13.04
15/64	0.2344	1-1/2	6	110142	19.15	13.41
9/32	0.2812	1-1/2	6	110157	21.53	15.07
19/64	0.2969	1-1/2	6	110162	14.08	9.86
5/16	0.3125	1-1/2	6	110167	20.08	14.06
21/64	0.3281	1-1/2	6	110172	24.43	17.10
11/32	0.3437	1-1/2	6	110177	24.43	17.10
23/64	0.3594	1-3/4	7	110182	24.43	17.10
3/8	0.3750	1-3/4	7	110187	21.53	15.07
25/64	0.3906	1-3/4	7	110192	25.46	17.82
13/32	0.4062	1-3/4	7	110197	26.29	18.40
27/64	0.4219	1-3/4	7	110202	27.74	19.42
11/16	0.6875	2-1/4	9	110282	44.40	31.08
3/4	0.7500	2-1/2	9-1/2	110292	49.37	34.56
7/8	0.8750	2-5/8	10	110312	64.07	44.85
15/16	0.9375	2-5/8	10	110322	71.93	50.35
1	1.0000	2-3/4	10-1/2	110332	79.49	55.64
1-1/8	1.1250	2-7/8	11	110342	99.77	69.84
1-1/4	1.2500	3	11-1/2	110352	123.68	86.58
1-3/8	1.3750	3-1/4	12	110362	148.42	103.89

CAT Taper End Mill Holders



- 100% forged construction
- Certified balanced @G2.5 up to 30,000 rpm
- Precision ground throughout
- DIN coolant thru the flange - standard



Taper	Hole Dia.	Gage Length	Spigot Dia.	Set Screw	Code No.	Reg. Price \$	SALE \$
CT40	1/4"	1.38"	0.79"	1/4-28	531000	145.03	94.27
CT40	1/4"	2.50"	0.79"	1/4-28	531002	145.03	94.27
CT40	1/4"	4.00"	0.79"	1/4-28	531004	159.28	103.53
CT40	5/16"	1.38"	0.87"	5/16-24	531006	157.98	102.69
CT40	5/16"	4.00"	0.87"	5/16-24	531010	139.13	90.43
CT40	5/16"	9.00"	0.87"	5/16-24	531011	292.51	190.13
CT40	3/8"	2.50"	1.00"	3/8-24	531014	157.98	102.69
CT40	3/8"	4.00"	1.00"	3/8-24	531016	159.28	103.53
CT40	3/8"	5.00"	1.00"	3/8-24	531018	176.11	114.47
CT40	7/16"	2.50"	1.38"	7/16-20	531020	139.13	90.43
CT50	3/8"	2.50"	1.00"	3/8-24	531100	194.24	126.26
CT50	3/8"	4.00"	1.00"	3/8-24	531102	216.25	140.56
CT50	1/2"	2.63"	1.38"	7/16-20	531118	183.88	119.52
CT50	1/2"	4.00"	1.38"	7/16-20	531120	216.25	140.56
CT50	5/8"	4.00"	1.65"	9/16-18	531130	212.65	138.22
CT50	3/4"	3.00"	1.89"	5/8-18	531138	185.17	120.36
CT50	1"	4.00"	2.36"	3/4-16	531154	216.25	140.56
CT50	1"	6.00"	2.36"	3/4-16	531156	220.71	143.46

* Stubby Length

Carbide Jobber Drills



- 118° 4-facet point
- 20° helix angle
- Bright finish
- Sub-micrograin carbide



For use on:

- Aluminum
- Titanium Alloy
- Low & Medium Carbon Steel
- Copper
- High Carbon Steel
- Glass, Plastics, Composite Materials
- Cast Iron
- Alloys Steel

Size (in.)	Decimal Equivalent	Flute Length (in.)	Overall Length (in.)	Code No.	Reg. Price \$	SALE \$
3/64	0.0469	3/4	1-1/2	170600	17.60	14.08
1/16	0.0625	3/4	1-1/2	170602	18.73	14.98
5/64	0.0781	7/8	1-3/4	170604	18.73	14.98
3/32	0.0938	1	2	170606	20.60	16.48
7/64	0.1094	1-1/4	2-1/4	170608	23.39	18.71
1/8	0.1250	1-1/4	2-1/4	170610	24.94	19.95
5/32	0.1562	1-3/8	2-1/2	170614	30.84	24.67
3/16	0.1875	1-5/8	2-3/4	170618	37.47	29.98
1/4	0.2500	2	3-1/4	170626	56.82	45.46
5/16	0.3125	2-1/8	3-1/2	170634	78.45	62.76
3/8	0.3750	2-3/4	4-1/4	170642	110.75	88.60
7/16	0.4375	2-7/8	4-1/2	170650	161.56	129.25

Individual Rectangular Gage Blocks



ASIMETO

Size (in.)	Code No.	Reg. Price \$	SALE \$
0.050	7651010	21.82	16.37
0.1004	7651200	20.77	15.58
0.1006	7651220	20.77	15.58
0.1008	7651240	20.77	15.58
0.1009	7651250	39.13	29.35
0.101	7651260	39.13	29.35
0.105	7651300	20.77	15.58
0.110	7651350	39.13	29.35
0.113	7651380	39.13	29.35
0.115	7651400	39.13	29.35
0.118	7651430	39.13	29.35
0.120	7651450	39.13	29.35
0.121	7651460	39.13	29.35
0.123	7651480	39.13	29.35
0.124	7651490	39.13	29.35
0.126	7651510	39.13	29.35
0.130	7651550	20.77	15.58
0.131	7651560	39.13	29.35
0.132	7651570	20.77	15.58
0.133	7651580	39.13	29.35
0.134	7651590	39.13	29.35
0.137	7651620	39.13	29.35
0.140	7651650	20.77	15.58
0.143	7651680	39.13	29.35
0.147	7651720	39.13	29.35
0.149	7651740	39.13	29.35
0.150	7651750	39.13	29.35
0.160	7651760	39.13	29.35
0.200	7651800	22.34	16.76
0.250	7651820	39.13	29.35
0.450	7651860	23.29	17.47
0.650	7651900	23.29	17.47
0.750	7651920	43.53	32.65
0.800	7651930	43.53	32.65
1.000	7651970	43.53	32.65

SHRINK FIT TOOLING



CAT Taper Shrink Fit Tooling with 4 Coolant Ports

4 COOLANT PORTS:

- Positioned in nose and angled 1° which concentrates coolant towards the cutting edge.

BALANCE:

- Pre-balanced to G2.5 up to 30,000 rpm.
- Machine balanceable.
- 4 Threaded holes for balancing screws.

MATERIAL:

- HSS-H13 for fast and proper heat induction increases life of shrink machine and spindle.
- 100% Forged construction (not turned down bar stock).

MAX GRIPPING TORQUE:

- Tool is gripped 360° along the entire length of bore, resulting in an evenly distributed clamping force.

UNSURPASSED ACCURACY:

- 0.0001 = 3µm with tool in holder.
- Traverse ground throughout.

NEW HOT DEAL!



CAT40

Taper	Hole Diameter	Gauge Length	Code No.	Reg. Price \$	SALE \$
CAT40	1/8"	3.15"	541838	424.59	275.98
CAT40	3/16"	3.15"	541840	424.59	275.98
CAT40	1/4"	3.15"	541842	424.59	275.98
CAT40	1/4"	6.30"	541844	500.13	325.08
CAT40	5/16"	3.15"	541846	424.59	275.98
CAT40	5/16"	6.30"	541848	500.13	325.08
CAT40	3/8"	3.15"	541850	424.59	275.98
CAT40	3/8"	6.30"	541852	500.13	325.08
CAT40	1/2"	3.15"	541854	424.59	275.98
CAT40	1/2"	6.30"	541856	500.13	325.08
CAT40	5/8"	3.15"	541858	424.59	275.98
CAT40	3/4"	3.15"	541862	424.59	275.98
CAT40	3/4"	6.30"	541864	500.13	325.08
CAT40	1"	3.94"	541866	424.59	275.98
CAT40	1"	6.30"	541868	500.13	325.08
CAT40	1-1/4"	3.94"	541870	424.59	275.98
CAT40	1-1/4"	6.30"	541872	619.40	402.61

Metric sizes also on promotion. See www.sowatool.com



CAT50

Taper	Hole Diameter	Gauge Length	Code No.	Reg. Price \$	SALE \$
CAT50	1/4"	3.15"	541932	395.81	257.28
CAT50	1/4"	6.30"	541934	619.40	402.61
CAT50	5/16"	3.15"	541936	395.81	257.28
CAT50	3/8"	3.15"	541940	462.29	300.49
CAT50	3/8"	6.30"	541942	619.40	402.61
CAT50	1/2"	3.15"	541944	462.29	300.49
CAT50	1/2"	6.30"	541946	619.40	402.61
CAT50	5/8"	3.15"	541948	462.29	300.49
CAT50	5/8"	6.30"	541950	719.11	467.42
CAT50	3/4"	3.15"	541952	530.34	344.72
CAT50	3/4"	6.30"	541954	661.70	430.11
CAT50	1"	3.94"	541956	530.34	344.72
CAT50	1"	6.30"	541958	676.81	439.93
CAT50	1-1/4"	3.94"	541960	530.34	344.72

Metric sizes also on promotion. See www.sowatool.com

Distributed by:

TECHNICUT

INDUSTRIAL SUPPLY INC.

Toll Free: 1-800-663-8845 Phone: (604) 888-4052
 #201-9466 189th Street, Surrey, B.C. V4N 4W7
 Fax: (604) 888-4072 email: sales@technicut.ca



Scan to download the flyer

Pricing valid from May 1 to August 31, 2021 or while quantities last.

We reserve the right to make changes without notice and accept no liabilities for mistakes and printing errors. All taxes extra.



Sowa Tool & Machine Co. Ltd.
 500 Manitow Drive
 Kitchener, Ontario
 N2C 1L3

Western Canada Branch
 9649-49th Ave
 Edmonton, AB
 T6E 5Z5

Toll Free: 1-800-265-8221
 Phone: (519) 748-5750
 Fax: (519) 748-9304
sales@sowatool.com
www.sowatool.com



Printed in Canada

* C A D I S S I *