

# SUMMER SIZZLER

## Dial Indicators Inch | AGD2

- Graduation: 0.001"/0.0005"
- Stem Diameter: Ø3/8"
- Easy to read dial face
- Internal tolerance marker
- Flat back (attached) and lug back supplied
- With counter pointer
- Short form calibration certificate included



910047

Magnetic Base Stands available on page 2



## Telescoping Gauges

- Spring-loaded plunger expands within the bore (or groove), allowing determination of the internal diameter
- With a knurled clamp



5/16-6"/8-150mm  
6pcs - A, B, C, D, E, F

Code 910174 **47.28**

## Electronic LEEB Hardness Testers

- Impact Device D
- Large screen (5 inches), showing all functions and parameters with background light
- Hardness test can be taken at any angle including inverted
- A wide measuring range supports the hardness of all metallic materials. Hardness results are directly displayed in HRB, HRC, HV, HB, HSD, HL, Mpa hardness scales
- Supports a variety of Richter sensors (DC, DL, C, D+15, G)
- Memory stores 500 records
- Tolerance alarm function
- Wireless printing capability
- Automatic power off after five minutes
- Battery: Lithium-ion, rechargeable
- Printer included
- Short form calibration certificate included



Printer included



170-960HLD | Accuracy: ±5HLD

Code 910074 **1565.77**



0-0.50"  
Graduation: 0.001"  
Dial Reading: 0-100  
Accuracy: ±0.002"

Code 910044 **41.77**

0-1"  
Graduation: 0.0005"  
Dial Reading: 0-50  
Accuracy: ±0.002"

Code 910047 **48.73**



YOUR AUTHORIZED KAR DISTRIBUTOR:

# TECHNICUT

INDUSTRIAL SUPPLY INC.

Unit 201-9466 189th Street, Surrey, B.C. V4N 4W7

**604.888.4052** Email: [sales@technicut.ca](mailto:sales@technicut.ca)

# SUMMER SIZZLER

## DID YOU KNOW?

We carry the complete range of SPI Precision Measuring Tools online — far beyond what's shown here.

Visit [KAR.ca](http://KAR.ca) for more details



### Microscope Flashlight

Standard  
Type F - Pen Style



Code 03894193 **36.42**

### Electronic Protractor (Angle Gauge)

- Measuring range: 0-360°
- Resolution: 0.05°
- Accuracy: ±0.15°
- Direct display angle values
- Easy lock angle system
- Specific HOLD key to lock the data
- V-groove design
- Battery: CR2032

Code 910069 **116.33**



### Step Drills

High Speed Steel  
Bright/Uncoated Finish | 3 Flats | Spiral Flute

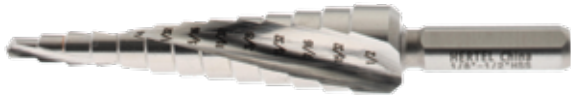

Max. Hole Dia. (Inch)	Shank Diameter (Inch)	Number of Steps	Min. Hole Dia. (Inch)	Step Length (Inch)	Code	Price
1/2	1/4	13	1/8	1/8	43274760	<b>16.48</b>
1/2	1/4	6	3/16	3/8	43274778	<b>16.48</b>
7/8	3/8	12	3/16	1/8	43274745	<b>36.18</b>
3/4	3/8	9	1/4	1/8	43274752	<b>29.74</b>
1	3/8	9	13/32	1/8	43274737	<b>39.20</b>
1-1/8	3/8	2	7/8	1/8	43274711	<b>53.23</b>
1-3/8	3/8	5	7/8	1/8	43274729	<b>66.93</b>

### Magnetic Base Stands



Standard

- Accepts test indicators with dovetail clamping mechanism
- Dial gauges can be held by the 3/8" or 8mm diameter stem or by the lug backing plate
- The rotary knob switches magnet on or off
- The precision surfaces and the bottom V are securely fastened to the ferrous workpiece or machine table when the rotary knob is in the on position
- 910065 with Fine Adjustment

910064

910065

176.37lbf/80kgf  
Code 910064

176.37lbf/80kgf  
Code 910065

176.37lbf/80kgf  
Code 910067

**29.46**

**27.28**

**71.39**

### Ball-Bearing Drill Chucks & Key

For Production Drilling Equipment

- Hardened and ground
- Fits tools up to 25mm (1")



LLAMBRICH

Capacity mm (Inch)	Mount	Dia. (mm)	Length Closed/Open (mm)	Weight (g)	Code	Price
1-13 (1/32-1/2)	J3	62	75/94	1,115	348144	<b>240.66</b>
1-16 (1/32-5/8)	J3	67	81/102	1,470	348145	<b>298.53</b>
1-19 (1/32-3/4)	J4	75	99/125	2,145	348146	<b>386.50</b>
5-25 (13/64-1)	J5	93	112/147	3,645	348147	<b>630.60</b>

### Precision Keyless Drill Chucks



Capacity (Inch)	Mount	Code	Price
0 - 1/4	J1	354100	<b>100.44</b>
0 - 1/4	3/8-24	354102	<b>100.44</b>
0 - 3/8	J2	354106	<b>127.50</b>
0 - 3/8	3/8-24	354108	<b>133.91</b>
1/32 - 1/2	J6	354112	<b>141.88</b>
1/32 - 1/2	J33	354114	<b>140.95</b>
1/32 - 1/2	1/2-20	354116	<b>133.63</b>
1/8 - 5/8	J6	354120	<b>172.51</b>
1/8 - 5/8	5/8-16	354122	<b>165.31</b>

# SUMMER SIZZLER

## Jobber Length Drills

Solid Carbide & High Speed Steel Gold-P Coated



### Solid Carbide | 118° Point

- For drilling steels in general – cast steels, cast iron, chilled cast iron, malleable cast iron, non-ferrous heavy metals, non-ferrous light metals, and abrasive plastics

\* HSS GOLD-P drills 135° split point on sizes 0.059" diameter and over

### HSS Gold-P Coated | \*135° Split Point

- Straight shank
- Flute Geometry: right hand spiral with wider flutes
- Point Angle: 135° split point on sizes 0.059" diameter and over
- Surface treatment: bright body with TiN coating on working part
- Application: drilling in steel, cast steel (alloyed and non-alloyed), grey cast iron, graphite, and malleable cast iron

Size (Inch)	Decimal (Inch)	SOLID CARBIDE				HSS GOLD-P COATED			
		118° POINT				135° SPLIT POINT			
		LOC (Inch)	OAL (Inch)	Code	Price	LOC (Inch)	OAL (Inch)	Code	Price
1/32	0.0312	5/16	1-1/4	952088	27.50	-	-	-	-
3/64	0.0469	3/4	1-1/2	952090	16.09	3/4	1-3/4	883020	1.90
1/16	0.0625	3/4	1-1/2	952092	16.19	7/8	1-7/8	883021	1.96
5/64	0.0781	7/8	1-3/4	952094	17.24	1	2	883022	1.96
3/32	0.0938	1	2	952096	19.53	1-1/4	2-1/4	883023	1.96
7/64	0.1094	1-1/4	2-1/4	952098	21.18	1-1/2	2-5/8	883024	1.96
1/8	0.1250	1-1/4	2-1/4	952100	22.19	1-5/8	2-3/4	883025	1.96
9/64	0.1406	1-3/8	2-1/2	952102	26.05	1-3/4	2-7/8	883026	2.05
5/32	0.1563	1-3/8	2-1/2	952104	27.47	2	3-1/8	883027	2.08
11/64	0.1719	1-5/8	2-3/4	952106	32.15	2-1/8	3-1/4	883028	2.20
3/16	0.1875	1-5/8	2-3/4	952108	32.57	2-5/16	3-1/2	883029	2.50
13/64	0.2031	1-3/4	3	952110	39.12	2-7/16	3-5/8	883030	3.03
7/32	0.2188	1-3/4	3	952112	40.26	2-1/2	3-3/4	883031	3.12
15/64	0.2344	2	3-1/4	952114	47.92	2-5/8	3-7/8	883032	3.55
1/4 (E)	0.2500	2	3-1/4	952116	47.92	2-3/4	4	883033	3.84
17/64	0.2656	2-1/8	3-1/2	952118	50.60	2-7/8	4-1/8	883034	4.27

Size (Inch)	Decimal (Inch)	SOLID CARBIDE				HSS GOLD-P COATED			
		118° POINT				135° SPLIT POINT			
		LOC (Inch)	OAL (Inch)	Code	Price	LOC (Inch)	OAL (Inch)	Code	Price
9/32	0.2812	2-1/8	3-1/2	952120	54.12	2-15/16	4-1/4	883035	4.74
19/64	0.2969	2-3/8	3-3/4	952122	60.13	3-1/16	4-3/8	883036	5.26
5/16	0.3125	2-3/8	4	952124	63.55	3-3/16	4-1/2	883037	5.71
21/64	0.3281	2-1/2	4	952126	69.19	3-5/16	4-5/8	883038	6.25
11/32	0.3438	2-1/2	4-1/4	952128	76.93	3-7/16	4-3/4	883039	7.03
23/64	0.3594	2-3/4	4-1/4	952130	83.88	3-1/2	4-7/8	883040	7.65
3/8	0.3750	2-3/4	4-1/2	952132	91.10	3-5/8	5	883041	7.85
25/64	0.3906	2-7/8	4-1/2	952134	102.92	3-3/4	5-1/8	883042	9.01
13/32	0.4062	2-7/8	4-1/2	952136	114.20	3-7/8	5-1/4	883043	9.32
27/64	0.4219	2-7/8	4-1/2	952138	125.09	3-15/16	5-3/8	883044	9.97
7/16	0.4375	2-7/8	4-1/2	952140	135.34	4-1/16	5-1/2	883045	10.93
29/64	0.4531	3	4-3/4	952142	146.58	4-3/16	5-5/8	883046	12.07
15/32	0.4688	3	4-3/4	952144	157.81	4-5/16	5-3/4	883047	12.77
31/64	0.4844	3	4-3/4	952146	162.47	4-3/8	5-7/8	883048	13.60
1/2	0.5000	3	4-3/4	952148	168.40	4-1/2	6	883049	14.27

## Countersinks

Metric | Cobalt M35 | TiN Coated



This highly productive countersinking cutter is a much improved version of the traditional multiflute milling cutter:

- wide flutes provide good chip evacuation
- positive cut
- constant profile aids regrinding of the tool
- self-centering of the cutting mill (three bearing points)
- virtually eliminates vibration
- Dimensions are adapted so as to sink 90 degree screw caps up to M12. We recommend lubricating

Overall Diameter (mm)	Shank Diameter (mm)	Chamfer Range Min/Max (mm)	Overall Length (Inch)	82° Angle Series 434	
				Code	Price
10.4	6	2.5-10.4	2	540311	43.82
16.5	10	3.2-16.5	2-1/4	540312	63.99
20.5	10	3.5-20.5	2-1/2	540313	71.81
25.0	10	3.8-25	2-5/8	540314	87.62
31.0	12	4.2-31	2-3/4	540315	130.33

**Carbide:**  
 Diameter 12.4 to 31  
 = 3 flatted shanks  
 Diameter 4.3 to 8.3  
 = cylindrical shank  
 Diameter 10.4 to 31  
 = brazed carbide head  
 \* Three gripping flats on shank

## Combined Drills & Countersinks

High Speed Steel M2

82° Angle | 60° Plain Type



Size	Body Diameter (Inch)	Point Diameter (Inch)	Point Length (Inch)	Overall Length (Inch)	Code	Price
000	1/8	0.020	1/32	1-1/4	540599	10.41
0	1/8	1/32	3/64	1-1/4	540610	9.07
1	1/8	3/64	1/16	1-1/4	540611	8.88
2	3/16	5/64	7/64	1-7/8	540612	9.30
3	1/4	7/64	9/64	2	540613	9.96
4	5/16	1/8	5/32	2-1/8	540614	11.42
4-1/2	3/8	9/64	3/16	2-1/2	540604	14.95
5	7/16	3/16	1/4	2-3/4	540615	16.67
6	1/2	7/32	19/64	3	540616	21.39
7	5/8	1/4	5/16	3-1/4	540617	41.05
8	3/4	5/16	13/32	3-1/2	540618	66.73
9	7/8	11/32	7/16	3-5/8	540619	125.05
10	1	3/8	1/2	3-3/4	540598	137.80

# SUMMER SIZZLER



## Carbide Turning Inserts

CCMT | DCMT | RCMT | SCMT | TCMT | VBMT | CNMG | DNMG

Shape	ANSI	Grade	Chipbreaker	Ø.I.C. (Inch)	Thickness (Inch)	Radius (Inch)	Code	Price
	CCMT2(1.5)1UF	YG3125	UF	0.254	0.094	0.016	577700	11.62
	CCMT2(1.5)2UG	YG3125	UG	0.254	0.094	0.031	577701	11.62
	CCMT3(2.5)1UR	YG3125	UR	0.381	0.156	0.016	577702	13.70
	CCMT3(2.5)2UG	YG3125	UG	0.381	0.156	0.031	577703	13.70
	CCMT432UG	YG3125	UG	0.508	0.187	0.031	577704	16.02
	DCMT2(1.5)1UF	YG3125	UF	0.305	0.094	0.016	577705	12.58
	DCMT3(2.5)1UF	YG3125	UF	0.458	0.156	0.016	577706	14.82
	DCMT3(2.5)2UG	YG3125	UG	0.458	0.156	0.031	577707	14.82
	RCMT0602M0	YG3125	-	-	0.094	-	577708	11.46
	RCMT0803M0	YG3125	-	-	0.125	-	577709	12.58
	RCMT10T3M0	YG3125	-	-	0.156	-	577710	13.70
	RCMT1204M0	YG3125	-	-	0.187	-	577711	15.40
	SCMT3(2.5)1UF	YG3125	UF	0.375	0.156	0.016	577712	14.82
	SCMT3(2.5)2UG	YG3125	UG	0.375	0.156	0.031	577713	14.82
	TCMT2(1.5)1UF	YG3125	UF	0.433	0.094	0.016	577714	12.58
	TCMT3(2.5)1UF	YG3125	UF	0.650	0.156	0.016	577715	16.54
	TCMT3(2.5)2UG	YG3125	UG	0.650	0.156	0.031	577716	16.54
	VBMT331UF	YG3125	UF	0.654	0.187	0.016	577717	20.40
	VBMT332UG	YG3125	UG	0.654	0.187	0.031	577718	20.40
	CNMG431UF	YG3125	UF	0.508	0.187	0.016	577719	16.02
	CNMG432UG	YG3125	UG	0.508	0.187	0.031	577720	16.02
	CNMG433UR	YG3125	UR	0.508	0.187	0.047	577721	16.02
	DNMG431UF	YG3125	UF	0.610	0.187	0.016	577722	19.36
	DNMG432UG	YG3125	UG	0.610	0.187	0.031	577723	19.36
	SNMG431UF	YG3125	UF	0.500	0.187	0.016	577724	16.02
	SNMG432UG	YG3125	UG	0.500	0.187	0.031	577725	16.02
	SNMG433UR	YG3125	UR	0.500	0.187	0.047	577726	16.02

Steel

Cast Iron

YG3125

PI5-P35

YG3030

P20-P35

YG1010

K05-K15

Can't find what you are looking for?

Ask your **KAR** Distributor for the full **YG-1** insert offering

# SUMMER SIZZLER

## Carbide Turning Inserts



SNMA | SNMG | TNMA | TNMG | TNUX | VNMG | WNMA | WNMG

Shape	ANSI	Grade	Chipbreaker	Ø.I.C. (Inch)	Thickness (Inch)	Radius (Inch)	Code	Price
	TNMG331UF	YG3125	UF	0.650	0.187	0.016	577727	14. <sup>82</sup>
	TNMG332UG	YG3125	UG	0.650	0.187	0.031	577728	14. <sup>82</sup>
	TNMG333UR	YG3125	UR	0.650	0.187	0.047	577729	14. <sup>82</sup>
	TNMG431UF	YG3125	UF	0.866	0.187	0.016	577730	18. <sup>14</sup>
	TNMG432UG	YG3125	UG	0.866	0.187	0.031	577731	18. <sup>14</sup>
	TNMG433UR	YG3125	UR	0.866	0.187	0.047	577732	18. <sup>14</sup>
	VNMG331UF	YG3125	UF	0.650	0.375	0.016	577733	20. <sup>40</sup>
	VNMG332UG	YG3125	UG	0.654	0.375	0.031	577734	20. <sup>40</sup>
	VNMG333UR	YG3125	UR	0.650	0.375	0.047	577735	20. <sup>40</sup>
	WNMG331UF	YG3125	UF	0.254	0.187	0.016	577736	13. <sup>70</sup>
	WNMG332UG	YG3125	UG	0.254	0.187	0.031	577737	13. <sup>70</sup>
	WNMG431UF	YG3125	UF	0.342	0.187	0.016	577738	16. <sup>02</sup>
	WNMG432UG	YG3125	UG	0.342	0.187	0.031	577739	16. <sup>02</sup>
	WNMG433UR	YG3125	UR	0.320	0.187	0.047	577740	16. <sup>02</sup>

Steel	Cast Iron	YG3125	PI5-P35	YG3030	P20-P35	YG1010	K05-K15
-------	-----------	--------	---------	--------	---------	--------	---------

## Colour Band Taps



High Speed Steel – Spiral Point Plug Style – 60° Point

Material		General Purpose				Hard Materials				Soft Materials			
Alloyed High Carbon Steel		✓											
Aluminum		✓								✓			
Brass/Bronze										✓			
Cast Iron										✓			
Copper										✓			
High Strength Steel		✓				✓							
Low Carbon Steel										✓			
Medium Carbon Steel		✓								✓			
Nickel Alloys						✓							
Stainless Steel		✓				✓							
Titanium		✓				✓							
Tool Steel		✓				✓							
Size	Overall Length (Inch)	No. of Flutes	Thread Length (Inch)	Code	Price	No. of Flutes	Thread Length (Inch)	Code	Price	No. of Flutes	Thread Length (Inch)	Code	Price
4-40	1-7/8	2	0.335	915060	11.11	2	0.335	915258	28.46	2	0.313	915170	7.86
6-32	2	3	0.413	915062	11.69	3	0.413	915262	23.69	2	0.375	915172	8.27
8-32	2-1/8	3	0.453	915066	11.69	3	0.453	915264	23.69	2	0.375	915176	8.27
10-32	2-3/8	3	0.531	915070	11.69	3	0.531	915268	23.69	2	0.500	915180	8.27
1/4-20	2-1/2	3	0.591	915074	13.49	3	0.591	915270	28.20	2	0.625	915184	9.59
5/16-18	2-23/32	3	0.669	915078	16.90	3	0.669	915274	31.25	2	0.688	915188	12.71
3/8-16	2-15/16	3	0.748	915082	17.26	3	0.748	915278	35.90	3	0.750	915192	12.97
1/2-13	3-3/8	3	0.984	915090	31.06	3	0.984	915286	56.22	3	0.938	915200	23.33
5/8-11	3-13/16	3	1.085	915094	32.08	3	1.085	915290	129.46	3	1.094	915204	23.97
3/4-10	4-1/4	3	1.201	915098	45.27	3	1.201	915294	167.29	3	1.219	915208	33.92

# SUMMER SIZZLER



## Magnifier Work Lights

Long Arm | JML-15RLD

- Built in LED Driver to connect to AC power
- High voltage power 100V-240V with plug

Code 302303

254.74

## LED Machine Lamps

Coolant Proof – IP20 | JHL-35R Series

- Built in LED Driver with Coil Transformer
- High voltage power 100V-260V with plug
- 3W LED lamp (3 x 1W LEDs)
- Coolant proof – IP20
- Various lighting angles: 30°, 45°, 60°
- Impact resistant clear lens
- Supplied with 1.8 meter power connection cord
- Engineered double plastic shade design allows fast heat dissipation

Short Code 302307      18 (9+9) Code 302308

219.96      222.39

32 (16+16) Code 302309

224.74

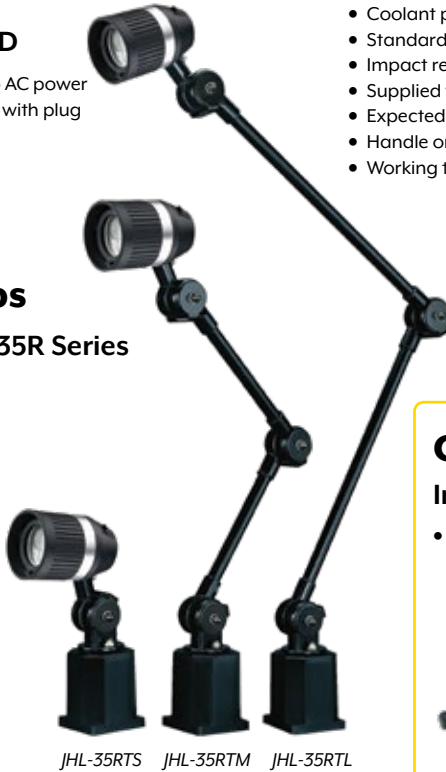

JHL-35RTS    JHL-35RTM    JHL-35RTL

## LED Machine Lamps

Coolant Proof – IP65 | JWL-55N Series

- LED driver in base
- High voltage power 100V-260V with plug
- 12W LED lamp (6 x 2W LEDs)
- Coolant proof – IP65
- Standard light beam angle: 60°
- Impact resistant clear lens
- Supplied with 1.8 meter power connection cord
- Expected lamp life of 40,000 hours
- Handle on head allows easy positioning
- Working temperature range: -30°C to +60°C



JWL-55NTS    JWL-55RNTM    JWL-55RNTL

JWL-55NTS – Short Code 302992

244.55

JWL-55NTM – 18" Code 302993

255.53

JWL-55NTL – 32" Code 302994

260.43

## Cross-Slide Table

Inch | Double Axis | Fixed Base

- General tolerance ±0.03"



Model: 340 XY  
Stroke X Axis: 100mm + 100mm  
Stroke Y Axis: 70mm + 70mm  
Weight: 60lbs | Code 266524

3073.40

Model: 800 XY  
Stroke X Axis: 250mm + 250mm  
Stroke Y Axis: 125mm + 125mm  
Poids: 60lbs | Code 266530

7211.78

WHILE QUANTITIES LAST | FOR MORE DIMENSIONS

[WWW.KAR.CA](http://WWW.KAR.CA)

## Tool Trolleys

With #40 & #50 Inserts



#40

#50

#40 Inserts | Code 214240  
#50 Inserts | Code 214250

6.62/ea.

866.38/ea.

With 28 pcs. #40 Inserts | Code 214140  
With 20 pcs. #50 Inserts | Code 214150

## BLOWOUT PRICES!

WHILE QUANTITIES LAST

## Clamping Sets

Tabletop Style

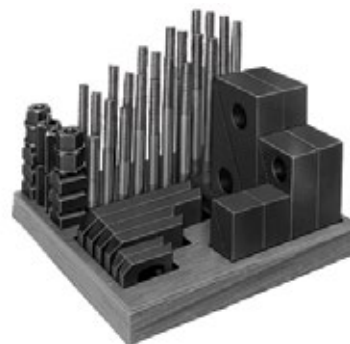

Table Slot: 13/16  
Stud Size: 3/4-10  
Block Width: 1-1/2  
Code 400035

574.02

Table Slot: 7/8  
Stud Size: 3/4-10  
Block Width: 1-1/2  
Code 400040

574.02

Table Slot: 1  
Stud Size: 7/8-9  
Block Width: 2  
Code 400045

760.52

# SUMMER SIZZLER

## Tool Clamping Fixtures



Fixed Vise Head



Rotary

MULTIPLE USE TOOL CLAMPS FOR  
TOOL SHANK ISO - DIN 69871  
CAT & BT-MAS

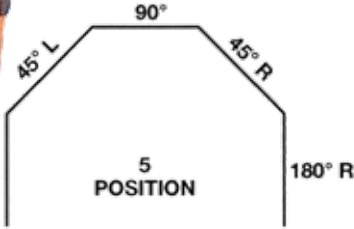

- Easy access for combined assembly of cutting tool and pull stud
- Head fixture can be set in five positions: vertical, horizontal and 45° (left and right)
- Efficiently designed for maximum protection of tool holder
- Enables strong gripping power of cutting tools
- Compact design - can be mounted on work table or tool cart

#40 ROTARY  
Code 827695

287.12

#50 ROTARY  
Code 827696

362.96

#40 FIXED  
Code 827697

97.68

#50 FIXED  
Code 827698

137.98

## Power Table Feed

### X-Axis

- Smooth running with high torque maximum of 650 in/lb
- New and stronger design assures long trouble-free life
- Electrical and mechanical parts are designed for easy maintenance

### Specifications:

Voltage: 110V, 50/60Hz  
Speed Range: 4-160 RPM  
Rapid Speed: 200 RPM  
Max. Torque: 650 lbs/in  
Dimensions:  
290 x 200 x 320mm

X-Axis | Code 302235

999.99



## Fixed Bench Vises



- Graded cast iron body
- Hardened and ground alloy steel jaws
- Perfectly aligned vise for smooth functioning

3" x 3-3/8" Opening  
Code 416250

81.44

4" x 4" Opening  
Code 416251

121.85

5" x 5" Opening  
Code 416252

162.56

6" x 6" Opening  
Code 416253

241.28

## Shop Rolls

50 Yards (22.86 meters) x 3 Rolls  
Aluminum Oxide | Coated



Size	Grade	Grit	Code	Price
1" x 50 yd	Medium	120	01135995	44.95
1" x 50 yd	Medium	80	01136019	40.06
1" x 50 yd	Medium	60	01136027	39.47
1-1/2" x 50 yd	Fine	120	01136118	64.57
2 x 50 yd	Medium	80	04009346	71.48
2 x 50 yd	Medium	60	04009353	77.29

## Carbide Burrs

Various Shapes & Sizes



20% OFF Starting at... \$3.90

SEE MORE HERTEL Production Grade Tooling | [www.kar.ca](http://www.kar.ca)

## Abrasive Roll Kits

25 Yards (22.86 meters) x 3 Rolls  
Aluminum Oxide | Coated



52437712 - Fine, Very Fine

Individual replacement rolls available

Size	Grade	Grit	Code	Price
1" x 25 yd	Fine, Very Fine	120, 180, 240	52437712	88.41
1" x 25 yd	Medium, Fine, Very Fine	80, 120, 180	52437720	88.41
1-1/2" x 25 yd	Fine, Very Fine	120, 180, 240	52437761	128.08
1-1/2" x 25 yd	Medium, Fine, Very Fine	80, 120, 180	52437779	128.08
2" x 25 yd	Fine, Very Fine	120, 180, 240	52437746	167.95
2" x 25 yd	Medium, Fine, Very Fine	80, 120, 180	52437753	164.44

# SUMMER SIZZLER

## CERAMIX Sets

### Heavy Duty Handles with Ceramic Blades

- Adjust cutting angle between blade and material for best results and prevent scratches
- Blade can be flipped for two types of jobs

**SHAVIV**  
Leading Deburring Solutions

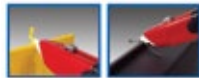

### SET Q10 Heavy Duty Handle with Ceramic Q10 Blade



Q10 Set  
with Q10 Blade  
Code 550722  
**32.15**

### SET Q12 Heavy Duty Handle with Curved Ceramic Q11 Blade



Q12 Set  
with Q11 Blade  
Code 550726  
**32.15**

### Individual Ceramic Blades

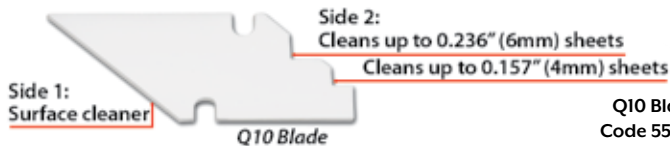

Q10 Blade  
Code 550723  
**24.36**

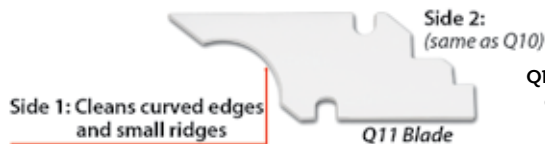

Q11 Curved Blade  
Code 550728  
**24.36**

## Maintenance File Set **CRESCENT NICHOLSON**



Code 60304896  
**212.91**

### 9 Pieces

- For home and professional use
- 10"/250mm flat bastard file, flat smooth file, mill bastard file, half-rounded bastard, round bastard file
- 8"/200mm flat smooth file, half-round bastard file, and four-in-hand file
- 6"/150mm slim taper file
- Complete set fits securely into rugged, compact pouch

## Scrape Burrs

**SHAVIV**  
Leading Deburring Solutions

### Scrape-Burr 42 The Heavy Duty Scraper

- Durable and secure
- Permanent heavy duty triangular blade with three cutting edges for high quality finishing and scraping



Code 550975  
**23.83**

### Scrape-Burr 40 The All-Purpose Scraper

- Useful and convenient all-purpose standard scraper
- Permanent heavy duty triangular blade with three cutting edges for high quality finishing and scraping



Code 550974  
**16.48**

### Scrape-Burr 400 The Fine Finish Scraper

- Miniature tool for a fine finish on precision work pieces
- Extra thin, heavy duty triangular blade with three cutting edges for high quality and accurate finishing and scraping



Code 550976  
**11.47**

**SHAVIV**

Exclusively Available at **KAR** in Canada

## Machinist's Tools

### Individual & 3 Piece Set

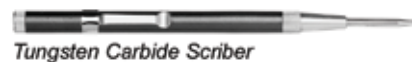

Tungsten Carbide Scriber



Automatic Center Punch



Pocket Magnet Pick-up

**3 Piece Set**  
Code 455505  
**40.08**

SCRIBER  
Code 455501  
**13.05**

CENTER PUNCH  
Code 455502  
**13.05**

MAGNETIC PICK-UP  
Code 455503  
**13.97**

### Pocket Scriber

Code 460070  
**7.92**



- Hardened steel point is reversible for protection when not in use
- Overall length: 89mm - 3-1/2"



**KAR Industrial Inc.**  
[www.kar.ca](http://www.kar.ca)

Toronto.....1-800-387-3127  
Montréal.....1-800-363-7862  
Edmonton.....1-866-440-4326

Offer valid until September 30, 2026

\*Products shown may not be exactly as illustrated Code 000352

MAKING IT EASY TO DO BUSINESS WITH SINCE 1954... CONTACT YOUR LOCAL KAR DISTRIBUTOR TODAY!